

# CT47 ULTRA-RUGGED MOBILE COMPUTER

Configuration Guide



SCAN HANDLE



RFID



VEHICLE DOCK



**CT47**  
STANDARD  
BATTERY



**CT47 NI**  
NON-INCENDIVE  
ATEX / IEC Ex



**CT47**  
EXTENDED  
BATTERY



  
**CT47**  
WIRELESS  
BATTERY

THE  
FUTURE  
IS  
WHAT  
WE  
MAKE IT

**Honeywell**

# TABLE OF CONTENTS

- 1**     **TABLE OF CONTENTS**
  
- 2**     **CT47 FEATURE OVERVIEW**
  - S0703 STANDARD RANGE
  - S0803FR FLEXRANGE™ NEAR/ FAR RANGE
  - S0803FR FLEXRANGE™ NEAR/ FAR RANGE - FIPS CERTIFIED
  - S0803FR FLEXRANGE™ NEAR/ FAR RANGE - WIRELESS BATTERY
  - S0803FR FLEXRANGE™ NEAR/ FAR RANGE - EXTENDED BATTERY
  - S0803 FLEXRANGE™ XLR NEAR/ EXTRA LONG RANGE
  - S0803 FLEXRANGE™ XLR NEAR/ EXTRA LONG RANGE - FIPS CERTIFIED
  - NON-INCENDIVE / ATEX / IEC EX - S0803FR FLEXRANGE™ NEAR/ FAR RANGE
  - NON-INCENDIVE / ATEX / IEC EX - S0803 FLEXRANGE™ XLR NEAR/ EXTRA LONG RANGE
  
- 11**    **CT47 CONFIGURATION MAP**
  - ANDROID
  
- 12**    **HONEYWELL EDGE SERVICES**
  - GOLD REPAIR SERVICES - 3 YEAR
  - PLATINUM REPAIR SERVICES - 3 YEAR
  - GOLD REPAIR SERVICES - 5 YEAR
  - PLATINUM REPAIR SERVICES - 5 YEAR
  - CT47 - REPAIR SERVICES COVERAGE
  
- 15**    **CT47 SOFTWARE**
  - DEVICE CLIENT PACK
  
- 16**    **CT47 SCANNING**
  - SCAN HANDLE SIDE BY SIDE COMPARISON
  
- 17**    **CT47 SCANNING**
  - OPTION 1 - SCAN HANDLE
  - OPTION 2 - SCAN HANDLE WITH PROTECTIVE BOOT
  - OPTION 3 - SCAN HANDLE WITH PROTECTIVE BOOT - HI-VISIBILITY
  
- 20**    **CT47 PROTECTIVE BOOT**
  - DOCKABLE PROTECTIVE BOOT
  - DOCKABLE PROTECTIVE BOOT - HI-VISIBILITY
  
- 22**    **CT47 DESKTOP COMMUNICATIONS**
  - OPTION 1 – PORTABLE - NON-BOOTED OR BOOTED
  - OPTION 2 – FIXED WITH UNIVERSAL CUP
  - OPTION 3 – USB TYPE C ON-THE-GO (OTG) DESKTOP
  - OPTION 4 – USB TYPE C ON-THE-GO (OTG) VEHICLE
  - OPTION 5 - DISPLAY BASE WITH UNIVERSAL CUP
  
- 25**    **CT47 VEHICLE INSTALL**
  - OPTION 1 – PORTABLE/ SUB CONTRACTOR INSTALL
  - OPTION 2 – PORTABLE/ SUB CONTRACTOR INSTALL
  - OPTION 3 - FIXED VEHICLE INSTALL WITH DIRECT CONNECTION TO VEHICLE BATTERY
  - OPTION 4 - FIXED VEHICLE INSTALL WITH DIRECT CONNECTION TO VEHICLE BATTERY - EXTERNAL SPEAKER
  - OPTION 5 - FIXED VEHICLE INSTALL WITH DIRECT CONNECTION TO VEHICLE BATTERY/ FUSE BLOCK
  - OPTION 6 - FIXED VEHICLE INSTALL WITH DIRECT CONNECTION TO VEHICLE BATTERY/ FUSE BLOCK - EXTERNAL SPEAKER
  - OPTION 7 - FIXED VEHICLE INSTALL WITH THOR DC/DC CONVERTER
  - OPTION 8 - FIXED VEHICLE INSTALL WITH THOR DC/DC CONVERTER - EXTERNAL SPEAKER
  
- 32**    **CT47 VEHICLE INSTALL**
  - CT45/ CT47 VEHICLE DOCK (CT45-VD-CNV) DETAIL VIEW - NON-BOOTED
  - CT45/ CT47 VEHICLE DOCK (CT45-VD-CNV) DETAIL VIEW - BOOTED
  - CT45/ CT47 VEHICLE DOCK WITH EXTERNAL SPEAKER (CT45-VD-CNV-SPK) DETAIL VIEW - NON-BOOTED
  - CT45/ CT47 VEHICLE DOCK WITH EXTERNAL SPEAKER (CT45-VD-CNV-SPK) DETAIL VIEW - BOOTED
  
- 36**    **CT47 VEHICLE INSTALL WIRELESS CHARGING**
  - OPTION 1 - FIXED VEHICLE INSTALL WITH DIRECT CONNECTION TO VEHICLE BATTERY
  - OPTION 2 - FIXED VEHICLE INSTALL WITH DIRECT CONNECTION TO VEHICLE BATTERY - EXTERNAL SPEAKER
  - OPTION 3 - FIXED VEHICLE INSTALL WITH DIRECT CONNECTION TO VEHICLE BATTERY/ FUSE BLOCK
  - OPTION 4 - FIXED VEHICLE INSTALL WITH DIRECT CONNECTION TO VEHICLE BATTERY/ FUSE BLOCK - EXTERNAL SPEAKER
  - OPTION 5 - FIXED VEHICLE INSTALL WITH THOR DC/DC CONVERTER
  - OPTION 6 - FIXED VEHICLE INSTALL WITH THOR DC/DC CONVERTER - EXTERNAL SPEAKER
  
- 42**    **CT47 VEHICLE INSTALL WIRELESS CHARGING**
  - CT47 WIRELESS VEHICLE DOCK (CTX-VD-CNV) DETAIL VIEW - NON-BOOTED
  - CT47 WIRELESS VEHICLE DOCK (CTX-VD-CNV) DETAIL VIEW - BOOTED
  - CT47 WIRELESS VEHICLE DOCK (CTX-VD-CNV-SPK) DETAIL VIEW - NON-BOOTED
  - CT47 WIRELESS VEHICLE DOCK (CTX-VD-CNV-SPK) DETAIL VIEW - BOOTED
  
- 46**    **CT47 VEHICLE INSTALL NON-POWERED HOLDER**
  - OPTION 1- FIXED NON-POWERED VEHICLE HOLDER WITH NON-BOOTED SCAN HANDLE
  - OPTION 2 - FIXED NON-POWERED VEHICLE HOLDER WITH BOOTED SCAN HANDLE
  
- 48**    **CT47 CHARGING AND COMMUNICATION**
  - OPTION 1 - NON-BOOTED QUAD CHARGER WITH UNIVERSAL CUP
  - OPTION 2 - BOOTED QUAD CHARGER WITH UNIVERSAL CUP
  - OPTION 3 - NON-BOOTED 5-BAY CHARGER WITH BATTERY CUP
  - OPTION 4 - BOOTED 5-BAY CHARGER WITH BATTERY CUP
  - OPTION 5 - NON-BOOTED 5-BAY CHARGER WITH UNIVERSAL CUPS
  - OPTION 6 - BOOTED 5-BAY CHARGER WITH UNIVERSAL CUPS
  - OPTION 7 - QUAD BATTERY CHARGER
  - OPTION 8 - 1-BAY QUAD BATTERY CHARGER WITH UNIVERSAL CUP
  
- 52**    **CT47 CHARGING AND COMMUNICATION**
  - RACK / WALL MOUNT BRACKET
  
- 53**    **CT47 BATTERY**
  - SPARE BATTERY OPTIONS
  
- 54**    **CT47 RFID**
  - IH45 RFID READER WITH CT47 NON-BOOTED
  - IH45 RFID READER WITH CT47 BOOTED
  
- 56**    **CT47 RFID CHARGING**
  - OPTION 1 - IH45 NON-BOOTED QUAD CHARGE
  - OPTION 2 - IH45 BOOTED QUAD CHARGER
  - OPTION 3 - IH45 QUAD BATTERY CHARGER
  
- 58**    **CT47 HEADSET**
  - USB-C CT47 PUSH TO TALK (PTT) HEADSET
  
- 59**    **MISCELLANEOUS**
  - OPTIONAL PARTS
  - MICRO-SD CARDS
  - AC CORDS

# CT47 FEATURE OVERVIEW

## S0703 Standard Range

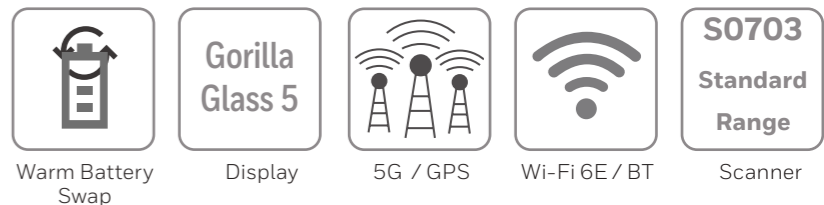

Included in the box:

- CT47 Mobile Computer
- Battery (CT4X-BTSC-001)
- USB Type C cable
- Hand strap
- SIM/SD Card Cover Screw

(Stylus is NOT included, but available to order separately as an accessory)



S0703 Standard Range



### CT47 Android - 5G WWAN - S0703 - 8GB RAM/ 128GB Flash

#### CT47-X1N-57D1E0G

CT47, 5G WWAN, 5.5 inch Display, Wi-Fi 6E 802.11 a/b/g/n/ac/d/h/i/r/k/v/w/mc/ax, 2x2 MU-MIMO, BT5.2 & 2nd BLE, 8GB RAM/128GB Flash, S0703 Standard Range, 13MP Rear Camera / 8MP Front Camera, Fingerprint Sensor, Android (GMS), Device Client Pack (DCP) Pre-Loaded (1 Year DCP Term License), 1x Nano SIM & 1x eSIM, Standard, 4,775mAh Standard Battery, Global

### CT47 Android - 5G WWAN - S0703 - 6GB RAM/ 128GB Flash

#### CT47-X1N-37D1E0G

CT47, 5G WWAN, 5.5 inch Display, Wi-Fi 6E 802.11 a/b/g/n/ac/d/h/i/r/k/v/w/mc/ax, 2x2 MU-MIMO, BT5.2 & 2nd BLE, 6GB RAM/128GB Flash, S0703 Standard Range, 13MP Rear Camera / 8MP Front Camera, Fingerprint Sensor, Android (GMS), Device Client Pack (DCP) Pre-Loaded (1 Year DCP Term License), 1x Nano SIM & 1x eSIM, Standard, 4,775mAh Standard Battery, Global

### CT47 Android - Wi-Fi Only - S0703 - 8GB RAM/ 128GB Flash

#### CT47-X0N-57D100G

CT47, WLAN, 5.5 inch Display, Wi-Fi 6E 802.11 a/b/g/n/ac/d/h/i/r/k/v/w/mc/ax, 2x2 MU-MIMO, BT5.2 & 2nd BLE, 8GB RAM/128GB Flash, S0703 Standard Range, 13MP Rear Camera / 8MP Front Camera, Fingerprint Sensor, Android (GMS), Device Client Pack (DCP) Pre-Loaded (1 Year DCP Term License), Standard, 4,775mAh Standard Battery, Global

### CT47 Android - Wi-Fi Only - S0703 - 6GB RAM/ 128GB Flash

#### CT47-X0N-37D100G

CT47, WLAN, 5.5 inch Display, Wi-Fi 6E 802.11 a/b/g/n/ac/d/h/i/r/k/v/w/mc/ax, 2x2 MU-MIMO, BT5.2 & 2nd BLE, 6GB RAM/128GB Flash, S0703 Standard Range, 13MP Rear Camera / 8MP Front Camera, Fingerprint Sensor, Android (GMS), Device Client Pack (DCP) Pre-Loaded (1 Year DCP Term License), Standard, 4,775mAh Standard Battery, Global

### Honeywell Repair Services

SVCCT47-SG3N

CT47, Edge Service, Gold Maintenance Contract, 3 Year, New Contract

ADD SVCREPLACE-MOB3

AddOn, Edge Service, Device Replacement, Mobility, 3 Year

# CT47 FEATURE OVERVIEW

## S0803FR FlexRange™ Near/ Far Range



Included in the box:

- CT47 Mobile Computer
- Battery (CT4X-BTSC-001)
- USB Type C cable
- Hand strap
- SIM/SD Card Cover Screw

(Stylus is NOT included, but available to order separately as an accessory)



S0803FR FlexRange™



### CT47 Android - 5G WWAN - S0803 FR - 8GB RAM/ 128GB Flash

#### CT47-X1N-58D1EOG

CT47, 5G WWAN, 5.5 inch Display, Wi-Fi 6E 802.11 a/b/g/n/ac/d/h/i/r/k/v/w/mc/ax, 2x2 MU-MIMO, BT5.2 & 2nd BLE, 8GB RAM/128GB Flash, S0803FR FlexRange, 13MP Rear Camera / 8MP Front Camera, Fingerprint Sensor, 4,775 mAh Standard Battery, Android (GMS), Device Client Pack (DCP) Pre-Loaded (1 Year DCP Term License), 1 x Nano SIM & 1 x eSIM, Standard, Global

#### CT47-X1N-38D1EOG

### CT47 Android - 5G WWAN - S0803 FR - 6GB RAM/ 128GB Flash

CT47, 5G WWAN, 5.5 inch Display, Wi-Fi 6E 802.11 a/b/g/n/ac/d/h/i/r/k/v/w/mc/ax, 2x2 MU-MIMO, BT5.2 & 2nd BLE, 6GB RAM/128GB Flash, S0803FR FlexRange, 13MP Rear Camera / 8MP Front Camera, Fingerprint Sensor, 4,775 mAh Standard Battery, Android (GMS), Device Client Pack (DCP) Pre-Loaded (1 Year DCP Term License), 1 x Nano SIM & 1 x eSIM, Standard, Global

### CT47 Android - Wi-Fi Only - S0803 FR - 8GB RAM/ 128GB Flash

#### CT47-X0N-58D100G

CT47, WLAN, 5.5 inch Display, Wi-Fi 6E 802.11 a/b/g/n/ac/d/h/i/r/k/v/w/mc/ax, 2x2 MU-MIMO, BT5.2 & 2nd BLE, 8GB RAM/128GB Flash, S0803FR FlexRange, 13MP Rear Camera / 8MP Front Camera, Fingerprint Sensor, 4,775 mAh Standard Battery, Android (GMS), Device Client Pack (DCP) Pre-Loaded (1 Year DCP Term License), Standard, Global

#### CT47-X0N-38D100G

### CT47 Android - Wi-Fi Only - S0803 FR - 6GB RAM/ 128GB Flash

CT47, WLAN, 5.5 inch Display, Wi-Fi 6E 802.11 a/b/g/n/ac/d/h/i/r/k/v/w/mc/ax, 2x2 MU-MIMO, BT5.2 & 2nd BLE, 6GB RAM/128GB Flash, S0803FR FlexRange, 13MP Rear Camera / 8MP Front Camera, Fingerprint Sensor, 4,775 mAh Standard Battery, Android (GMS), Device Client Pack (DCP) Pre-Loaded (1 Year DCP Term License), Standard, Global

### Honeywell Repair Services

SVCCT47-SG3N

CT47, Edge Service, Gold Maintenance Contract, 3 Year, New Contract

ADD SVCREPLACE-MOB3

AddOn, Edge Service, Device Replacement, Mobility, 3 Year

# CT47 FEATURE OVERVIEW

## S0803FR FlexRange™ Near/ Far Range - FIPS Certified

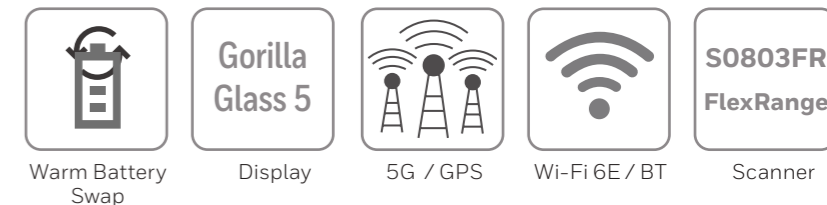

Included in the box:

- CT47 Mobile Computer
- Battery (CT4X-BTSC-001)
- USB Type C cable
- Hand strap
- SIM/SD Card Cover Screw

(Stylus is NOT included, but available to order separately as an accessory)



S0803FR FlexRange™



### CT47 Android - 5G WWAN - S0803 FR - 8GB RAM/ 128GB Flash - FIPS Certified

#### CT47-X1N-58D6E0G

CT47, 5G WWAN, 5.5 inch Display, Wi-Fi 6E 802.11 a/b/g/n/ac/d/h/i/r/k/v/w/mc/ax, 2x2 MU-MIMO, BT5.2 & 2nd BLE, 8GB RAM/128GB Flash, S0803FR FlexRange, 13MP Rear Camera / 8MP Front Camera, Fingerprint Sensor, 4,775 mAh Standard Battery, Android (Non-GMS) FIPS Certified, Device Client Pack (DCP) Pre-Loaded (1 Year DCP Term License), 1x Nano SIM & 1x eSIM, Standard, Global

#### Honeywell Repair Services

SVCCT47-SG3N

CT47, Edge Service, Gold Maintenance Contract, 3 Year, New Contract

ADD SVCREPLACE-MOB3

AddOn, Edge Service, Device Replacement, Mobility, 3 Year

# CT47 FEATURE OVERVIEW

## S0803FR FlexRange™ Near/ Far Range - Wireless Battery

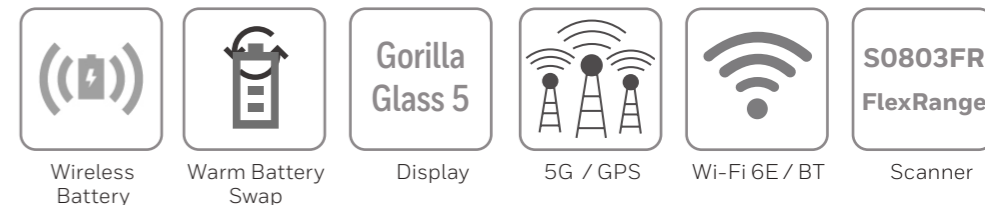

Included in the box:

- CT47 Mobile Computer
- Battery (CT4X-BTWC-001)
- USB Type C cable
- Hand strap
- SIM/SD Card Cover Screw

(Stylus is NOT included, but available to order separately as an accessory)



S0803FR FlexRange™



### CT47 Android - 5G WWAN - S0803 FR - 8GB RAM/ 128GB Flash

**CT47-X1N-58W1EOG** CT47, 5G WWAN, 5.5 inch Display, Wi-Fi 6E 802.11 a/b/g/n/ac/d/h/i/r/k/v/w/mc/ax, 2x2 MU-MIMO, BT5.2 & 2nd BLE, 8GB RAM/128GB Flash, S0803FR FlexRange, 13MP Rear Camera / 8MP Front Camera, Fingerprint Sensor, 4,680 mAh Wireless Battery, Android (GMS), Device Client Pack (DCP) Pre-Loaded (1 Year DCP Term License), 1 x Nano SIM & 1 x eSIM, Standard, Global

#### Honeywell Repair Services

SVCCT47-SG3N

CT47, Edge Service, Gold Maintenance Contract, 3 Year, New Contract

ADD SVCREPLACE-MOB3

AddOn, Edge Service, Device Replacement, Mobility, 3 Year

# CT47 FEATURE OVERVIEW

## SO803FR FlexRange™ Near/ Far Range – Extended Battery

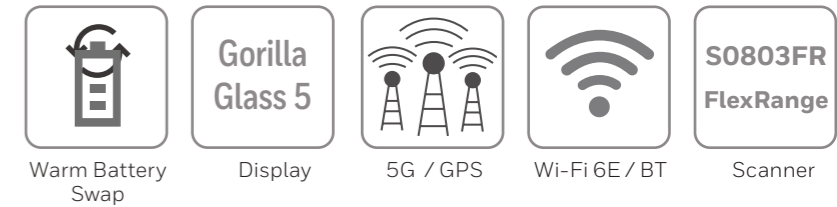

Included in the box:

- CT47 Mobile Computer
- Extended Battery (CT4X-BTEC-001)
- USB Type C cable
- Extended Hand strap
- SIM/SD Card Cover Screw

(Stylus is NOT included, but available to order separately as an accessory)



S0803FR FlexRange™



### CT47 Android - 5G WWAN - S0803 FR - 8GB RAM/ 128GB Flash

#### CT47-X1N-58E1EOG

CT47, 5G WWAN, 5.5 inch Display, Wi-Fi 6E 802.11 a/b/g/n/ac/d/h/i/r/k/v/w/mc/ax, 2x2 MU-MIMO, BT5.2 & 2nd BLE, 8GB RAM/128GB Flash, S0803FR FlexRange, 13MP Rear Camera / 8MP Front Camera, Fingerprint Sensor, 7,692 mAh Extended Battery, Android (GMS), Device Client Pack (DCP) Pre-Loaded (1 Year DCP Term License), 1 x Nano SIM & 1 x eSIM, Standard, Global

#### Honeywell Repair Services

SVCCT47-SG3N

CT47, Edge Service, Gold Maintenance Contract, 3 Year, New Contract

ADD SVCREPLACE-MOB3

AddOn, Edge Service, Device Replacement, Mobility, 3 Year

# CT47 FEATURE OVERVIEW

## S0803 FlexRange™ XLR Near/ Extra Long Range

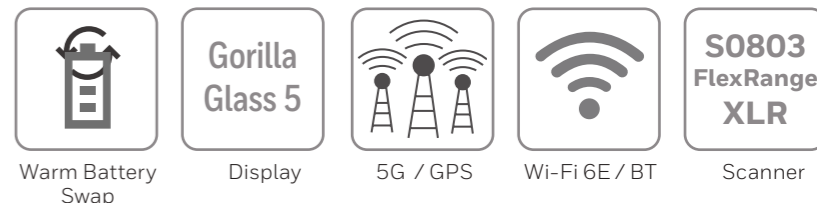

Included in the box:

- CT47 Mobile Computer
- Battery (CT4X-BTSC-001)
- USB Type C cable
- Hand strap
- SIM/SD Card Cover Screw

(Stylus is NOT included, but available to order separately as an accessory)



S0803 FlexRange™ XLR



### CT47 Android - 5G WWAN - S0803 XLR - 8GB RAM/ 128GB Flash

#### CT47-X1N-5ED1EOG

CT47, 5G WWAN, 5.5 inch Display, Wi-Fi 6E 802.11 a/b/g/n/ac/d/h/i/r/k/v/w/mc/ax, 2x2 MU-MIMO, BT5.2 & 2nd BLE, 8GB RAM/128GB Flash, S0803 FlexRange XLR, 13MP Rear Camera / 8MP Front Camera, Fingerprint Sensor, Android (GMS), Device Client Pack (DCP) Pre-Loaded (1 Year DCP Term License), 1x Nano SIM & 1x eSIM, Standard, 4,775mAh Standard Battery, Global

### CT47 Android - 5G WWAN - S0803 XLR - 6GB RAM/ 128GB Flash

#### CT47-X1N-3ED1EOG

CT47, 5G WWAN, 5.5 inch Display, Wi-Fi 6E 802.11 a/b/g/n/ac/d/h/i/r/k/v/w/mc/ax, 2x2 MU-MIMO, BT5.2 & 2nd BLE, 6GB RAM/128GB Flash, S0803 FlexRange XLR, 13MP Rear Camera / 8MP Front Camera, Fingerprint Sensor, Android (GMS), Device Client Pack (DCP) Pre-Loaded (1 Year DCP Term License), 1x Nano SIM & 1x eSIM, Standard, 4,775mAh Standard Battery, Global

### CT47 Android - Wi-Fi Only - S0803 XLR - 8GB RAM/ 128GB Flash

#### CT47-X0N-5ED100G

CT47, WLAN, 5.5 inch Display, Wi-Fi 6E 802.11 a/b/g/n/ac/d/h/i/r/k/v/w/mc/ax, 2x2 MU-MIMO, BT5.2 & 2nd BLE, 8GB RAM/128GB Flash, S0803 FlexRange XLR, 13MP Rear Camera / 8MP Front Camera, Fingerprint Sensor, Android (GMS), Device Client Pack (DCP) Pre-Loaded (1 Year DCP Term License), Standard, 4,775mAh Standard Battery, Global

### CT47 Android - Wi-Fi Only - S0803 XLR - 6GB RAM/ 128GB Flash

#### CT47-X0N-3ED100G

CT47, WLAN, 5.5 inch Display, Wi-Fi 6E 802.11 a/b/g/n/ac/d/h/i/r/k/v/w/mc/ax, 2x2 MU-MIMO, BT5.2 & 2nd BLE, 6GB RAM/128GB Flash, S0803 FlexRange XLR, 13MP Rear Camera / 8MP Front Camera, Fingerprint Sensor, Android (GMS), Device Client Pack (DCP) Pre-Loaded (1 Year DCP Term License), Standard, 4,775mAh Standard Battery, Global

### Honeywell Repair Services

SVCCT47-SG3N

CT47, Edge Service, Gold Maintenance Contract, 3 Year, New Contract

ADD SVCREPLACE-MOB3

AddOn, Edge Service, Device Replacement, Mobility, 3 Year



# CT47 FEATURE OVERVIEW

## S0803 FlexRange™ XLR Near/ Extra Long Range - FIPS Certified



Included in the box:

- CT47 Mobile Computer
- Battery (CT4X-BTSC-001)
- USB Type C cable
- Hand strap
- SIM/SD Card Cover Screw

(Stylus is NOT included, but available to order separately as an accessory)



S0803 FlexRange™ XLR



### CT47 Android - 5G WWAN - S0803 XLR - 8GB RAM/ 128GB Flash - FIPS Certified

#### CT47-X1N-5ED6E0G

CT47, 5G WWAN, 5.5 inch Display, Wi-Fi 6E 802.11 a/b/g/n/ac/d/h/i/r/k/v/w/mc/ax, 2x2 MU-MIMO, BT5.2 & 2nd BLE, 8GB RAM/128GB Flash, S0803 FlexRange XLR, 13MP Rear Camera / 8MP Front Camera, Fingerprint Sensor, 4,775 mAh Standard Battery, Android (Non-GMS) FIPS Certified, Device Client Pack (DCP) Pre-Loaded (1 Year DCP Term License), 1 x Nano SIM & 1 x eSIM, Standard, Global

#### Honeywell Repair Services

SVCCT47-SG3N

CT47, Edge Service, Gold Maintenance Contract, 3 Year, New Contract

ADD SVCREPLACE-MOB3

AddOn, Edge Service, Device Replacement, Mobility, 3 Year

# CT47 FEATURE OVERVIEW

## Non-Incendive / ATEX / IEC Ex - S0803FR FlexRange™ Near/ Far Range



Included in the box:

- CT47 Mobile Computer
- Battery (CT4X-BTNA-001)
- USB Type C cable
- Hand strap
- SIM/SD Card Cover Screw

(Stylus is NOT included, but available to order separately as an accessory)



S0803FR FlexRange™



### CT47 Android - 5G WWAN - S0803 FR - 8GB RAM/ 128GB Flash

#### CT47-X1N-58D1E1G

CT47, 5G WWAN, 5.5 inch Display, Wi-Fi 6E 802.11 a/b/g/n/ac/d/h/i/r/k/v/w/mc/ax, 2x2 MU-MIMO, BT5.2 & 2nd BLE, 8GB RAM/128GB Flash, S0803FR FlexRange, 13MP Rear Camera / 8MP Front Camera, Fingerprint Sensor, 4,775 mAh Standard Battery, Android (GMS), Device Client Pack (DCP) Pre-Loaded (1 Year DCP Term License), 1x Nano SIM & 1 x eSIM, Non-Incendive (NI) / ATEX / IEC Ex, Global

#### Honeywell Repair Services

SVCCT47-SG3N

CT47, Edge Service, Gold Maintenance Contract, 3 Year, New Contract

ADD SVCREPLACE-MOB3

AddOn, Edge Service, Device Replacement, Mobility, 3 Year

# CT47 FEATURE OVERVIEW

## Non-Incendive / ATEX / IEC Ex - S0803 FlexRange™ XLR Near/ Extra Long Range



Included in the box:

- CT47 Mobile Computer
- Battery (CT4X-BTNA-001)
- USB Type C cable
- Hand strap
- SIM/SD Card Cover Screw

(Stylus is NOT included, but available to order separately as an accessory)



S0803 FlexRange™ XLR



### CT47 Android - 5G WWAN - S0803 XLR - 8GB RAM/ 128GB Flash

#### CT47-X1N-5ED1E1G

CT47, 5G WWAN, 5.5 inch Display, Wi-Fi 6E 802.11 a/b/g/n/ac/d/h/i/r/k/v/w/mc/ax, 2x2 MU-MIMO, BT5.2 & 2nd BLE, 8GB RAM/128GB Flash, S0803 FlexRange XLR, 13MP Rear Camera / 8MP Front Camera, Fingerprint Sensor, Android (GMS), Device Client Pack (DCP) Pre-Loaded (1 Year DCP Term License), 1 x Nano SIM & 1 x eSIM, Non-Incendive (NI) / ATEX / IEC Ex, 4,775mAh NI/ATEX/IECEX Battery, Global

#### Honeywell Repair Services

SVCCT47-SG3N





CT47, Edge Service, Gold Maintenance Contract, 3 Year, New Contract

ADD SVCREPLACE-MOB3

AddOn, Edge Service, Device Replacement, Mobility, 3 Year

# CT47 CONFIGURATION MAP

## Android

		BLUETOOTH/WI-FI	WWAN	NFC	MEMORY	IMAGER	CAMERA	OPERATING SYSTEM	SIM	OPTIONS	DOMAIN	DESCRIPTION	NOTES
<b>CT47-</b>													
X												Wi-Fi 6E 802.11 a/b/g/n/ac/mc/ax, 2x2 MU-MIMO + Bluetooth 5.2	IEEE 802.11 a/b/g/n/ac/d/h/i/r/k/v/w/mc/ax, 2x2 MU-MIMO ; Wi-Fi certified, Wi-Fi 6E certified Bluetooth V5.2 and BLE Supported Bluetooth Profiles: HFP, PBAP, A2DP, AVRCP, OPP, SPP, GATT
	0											No WWAN	
	1											5G, LTE (4G) GPS, UMTS/HSPA+ (3G) GSM/GPRS/EDGE	WWAN RADIO (ATT/VZW/SPRINT/TMO/NA/EU) 5G FR1 - BANDS 1,2,3,4,5,7,8,12,14,20,25,28,30,38,40,41,48,66,71,77,78,79 LTE - BANDS 1,2,3,4,5,7,8,12,13,14,17,18,19,20,25,26,28,29,30,32,38,39,40,41,42,43,66,71 UMTS/HSPA+ (3G) - BANDS 1, 2, 4, 5, 6, 8, 9, 19 / GSM/GPRS/EDGE QUAD-BAND (850/900/1800/1900 MHZ)
				N								Near Field Communications (NFC)	Integrated NFC reader, compliant with ISO/IEC 14443 A, ISO/IEC 14443 B, ISO/IEC 15693 (ICODE), MIFARE 1K / 4K, MIFARE DESFire, Sony FeliCa, ISO/IEC 18092 (Type F)
				--									
					3							6GB RAM, 128GB Flash Memory	Qualcomm QCS6490/QCM6490 octa-core, 2.7GHz
					5							8GB RAM, 128GB Flash Memory	Qualcomm QCS6490/QCM6490 octa-core, 2.7GHz
						7						1D/2D Imager (S0703SR) – Standard Range	
						8						1D/2D Imager (N6803FR) – FlexRange™	 September 2023 - S0803FR (Green Laser) was cut-in to replace N6803FR (Red Laser)
						8						1D/2D Imager (S0803FR) – FlexRange™	
						E						1D/2D Imager (S0803) – FlexRange™ XLR	
						D						13MP Rear Camera / 8MP Front Camera	
							1					Android (GMS)	Google Mobile Services (GMS) certified – Play Store
							2					Android (Non-GMS)	
							6					Android (Non-GMS) - FIPS Certified	FIPS 140-2 Level 1
							0					No SIM slot	
							E					1 x eSIM & 1 x Nano SIM Slot	
								0				Standard	
								1				Non-Incendive (NI) / ATEX / IEC Ex	
									G			Global (WWAN or Wi-Fi)	Algeria, Argentina, Australia, Austria, Belarus, Belgium, Bolivia, Brazil, Canada, Chile, Colombia, Costa Rica, Croatia, Czech Republic, Denmark, Dominican Republic, Ecuador, Egypt, Estonia, Finland, France, Germany, Greece, Guatemala, Hong Kong, Hungary, India, Ireland, Israel, Italy, Japan, Lithuania, Malaysia, Mexico, Morocco, Netherlands, New Zealand, Norway, Peru, Philippines, Poland, Portugal, Romania, Russian Fed., Saudi Arabia, Serbia, Singapore, Slovakia, Slovenia, South Africa, South Korea, Spain, Sweden, Switzerland, Taiwan, Thailand, Tunisia, Turkey, UAE, Ukraine, United Kingdom, United States of America



# HONEYWELL EDGE SERVICES

## CT47 – Repair Services

Honeywell Edge Services give you the confidence of having leading-class technologies combined with service and support plans that are designed to keep you operational for longer.

For a full description of maintenance services, including terms and conditions, please see <https://sps.honeywell.com/us/en/services/productivity/support-services/maintenance-services>

### Gold Repair Services – 3 Year

The Edge Services Gold Support contract allows flexibility for you to select the right coverage for your organization, including 5-Day Depot Repairs and:

#### Service Overview

- Repair or replacement (at Honeywell discretion) for damaged components, wear and tear, accidental damage
- Flexibility to add any Add-On Service
- Android Service - includes Android OS Upgrades, Maintenance Releases and Security Patches

PART NUMBER	DESCRIPTION
SVCCT47-SG3N	CT47, Edge Service, GOLD Maintenance Contract, 5 Day Turnaround, <b>3 Year</b> , New Contract

#### Add-On Accessory Replacement Service

Provides replacement chargers, docks, charging cables, or scan handles should they be damaged or stop working.

<b>ADD</b> SVCACC-MOB3	AddOn, Edge Service, Accessory Service , Mobility, <b>3 Year</b> . Service covers docks, charger cradles, scan handles
------------------------	--

#### Add-On Battery Replacement Service

Provides replacement batteries as needed after a minimum of 18 months post-purchase.

<b>ADD</b> SVCBATTERY-MOB3	AddOn, Edge Service, Battery Service, Mobility, <b>3 Year</b> , 1 Replacement Battery over life of contract
----------------------------	---

#### Add-On Device Replacement Service

Replacement devices should a device be damaged beyond repair.

<b>ADD</b> SVCREPLACE-MOB3	AddOn, Edge Service, Device Replacement, Mobility, <b>3 Year</b>
----------------------------	--

#### Add-On Image Management Service

Ensures that when a device returns from being repaired, it has all the proper applications loaded back on the device.

<b>ADD</b> SVCIMAGEMGMT-MOB3	AddOn, Edge Service, Image Service, Mobility, <b>3 Year</b>
------------------------------	---

#### Add-On Spare Management Service

Manages your spare pool.

<b>ADD</b> SVCSPAREMGMT-MOB3	AddOn, Edge Service, Advanced Exchange, Mobility, <b>3 Year</b> . Customer owned spare pool, Minimum Purchase required, contact your local Honeywell Service Representative for more information.
------------------------------	---

#### Add-On 2-Day Turnaround Depot Upgrade

Upgrade your Gold Maintenance Contract from 5-Day to 2-Day turnaround at the repair depot.

<b>ADD</b> SVC2DAYDEPOT-MOB3	AddOn, Edge Service, 2-Day Depot Upgrade, 3-Year Agreement, Requires purchase of a <b>3 Year</b> Gold Maintenance Contract.
------------------------------	---

### Platinum Repair Services – 3 Year

The Edge Services Platinum Support contract offers 2-Day Depot Repairs or Spare Pool Management with 3 year contract that includes:

#### Service Overview

- Repair or replacement (at Honeywell discretion) for damaged components, wear and tear, accidental damage
- SVCREPLACE-MOB3 - Replacement devices should a device be damaged beyond repair
- SVCACC-MOB3 - Accessory replacement service
- SVCBATTERY-MOB3 - Battery replacement service
- SVCSPAREMGMT-MOB3 - Spare pool management (optional, minimum quantity required)
- Telephone-based technical support
- Android Service - includes Android OS Upgrades, Maintenance Releases and Security Patches

PART NUMBER	DESCRIPTION
SVCCT47-SP3N	CT47, Edge Service, PLATINUM, 2 Day Turnaround, <b>3 Year</b> , New Contract



# HONEYWELL EDGE SERVICES

## CT47 – Repair Services

Honeywell Edge Services give you the confidence of having leading-class technologies combined with service and support plans that are designed to keep you operational for longer.

For a full description of maintenance services, including terms and conditions, please see <https://sps.honeywell.com/us/en/services/productivity/support-services/maintenance-services>

### Gold Repair Services – 5 Year

The Edge Services Gold Support contract allows flexibility for you to select the right coverage for your organization, including 5-Day Depot Repairs and:

#### Service Overview

- Repair or replacement (at Honeywell discretion) for damaged components, wear and tear, accidental damage
- Flexibility to add any Add-On Service
- Android Service - includes Android OS Upgrades, Maintenance Releases and Security Patches

PART NUMBER	DESCRIPTION
SVCCT47-SG5N	CT47, Edge Service, GOLD Maintenance Contract, 5 Day Turnaround, <b>5 Year</b> , New Contract

#### Add-On Accessory Replacement Service

Provides replacement chargers, docks, charging cables, or scan handles should they be damaged or stop working.

<b>ADD</b> SVCACC-MOB5	AddOn, Edge Service, Accessory Service , Mobility, <b>5 Year</b> . Service covers docks, charger cradles, scan handles
------------------------	--

#### Add-On Battery Replacement Service

Provides replacement batteries as needed after a minimum of 18 months post-purchase.

<b>ADD</b> SVCBATTERY-MOB5	AddOn, Edge Service, Battery Service, Mobility, <b>5 Year</b> , 2 Replacement Battery over life of contract
----------------------------	---

#### Add-On Device Replacement Service

Replacement devices should a device be damaged beyond repair.

<b>ADD</b> SVCREPLACE-MOB5	AddOn, Edge Service, Device Replacement, Mobility, <b>5 Year</b>
----------------------------	--

#### Add-On Image Management Service

Ensures that when a device returns from being repaired, it has all the proper applications loaded back on the device.

<b>ADD</b> SVCIMAGEMGMT-MOB5	AddOn, Edge Service, Image Service, Mobility, <b>5 Year</b>
------------------------------	---

#### Add-On Spare Management Service

Manages your spare pool.

<b>ADD</b> SVCSPAREMGMT-MOB5	AddOn, Edge Service, Advanced Exchange, Mobility, <b>5 Year</b> . Customer owned spare pool, Minimum Purchase required, contact your local Honeywell Service Representative for more information.
------------------------------	---

#### Add-On 2-Day Turnaround Depot Upgrade

Upgrade your Gold Maintenance Contract from 5-Day to 2-Day turnaround at the repair depot.

<b>ADD</b> SVC2DAYDEPOT-MOB5	AddOn, Edge Service, 2-Day Depot Upgrade, 5-Year Agreement, Requires purchase of a <b>5 Year</b> Gold Maintenance Contract.
------------------------------	---

### Platinum Repair Services – 5 Year

The Edge Services Platinum Support contract offers 2-Day Depot Repairs or Spare Pool Management with 5 year contract that includes:

#### Service Overview

- Repair or replacement (at Honeywell discretion) for damaged components, wear and tear, accidental damage
- SVCREPLACE-MOB5 - Replacement devices should a device be damaged beyond repair
- SVCACC-MOB5 - Accessory replacement service
- SVCBATTERY-MOB5 - Battery replacement service
- SVCSPAREMGMT-MOB5 - Spare pool management (optional, minimum quantity required)
- Telephone-based technical support
- Android Service - includes Android OS Upgrades, Maintenance Releases and Security Patches

PART NUMBER	DESCRIPTION
SVCCT47-SP5N	CT47, Edge Service, PLATINUM, 2 Day Turnaround, <b>5 Year</b> , New Contract



# HONEYWELL REPAIR SERVICES

## CT47 - Repair Services Coverage

Service options tailored to customer requirements



CT47

Warranty Cover Against Product Defect

**BASIC Service**

**Gold Coverage:**

- Accidental Damage
- Wear & Tear
- Android Service

Includes Replacement of:

- Handstrap
- Screen Protector



Flexible GOLD Add-Ons ordered separately

- SVCACC-MOB3      Accessories
- SVCBATTERY-MOB3      Batteries
- SVCREPLACE-MOB3      Device Replacement
- SVCIMAGEMGMT-MOB3      Image Service
- SVCSPAREMGMT-MOB3      Advanced Exchange

**GOLD Service**

**Platinum Coverage**

- Battery Replacement
- Coverage for Docks/ Chargers
- Android Service

- Accidental Damage
- Device Replacement
- Wear & Tear



Pistol Grip



Vehicle Dock



Car Chargers



Battery  
(3 Year – 1 replacement battery per CT47)  
(5 Year – 2 replacement batteries per CT47)



Docks



Dock Power Supplies

**PLATINUM Service**

COVERAGE	PART NUMBER	DESCRIPTION
<b>BASIC</b>	SVCCT47-EXW2	CT47, BASIC, 10-15 Day Turnaround, 2 Years (1 Year Factory Warranty + 1 Year Extended)
<b>GOLD</b>	SVCCT47-SG3N	CT47, Edge Service, GOLD Maintenance Contract, 5 Day Turnaround, 3 Year, New Contract
<b>ADD</b>	SVCACC-MOB3	AddOn, Edge Service, Accessory Service, Mobility, 3 Year. Service covers docks, charger cradles, scan handles and car adapter
<b>ADD</b>	SVCBATTERY-MOB3	AddOn, Edge Service, Battery Service, Mobility, 3 Year, 1 Replacement Battery over life of contract
<b>ADD</b>	SVCREPLACE-MOB3	AddOn, Edge Service, Device Replacement, Mobility, 3 Year
<b>ADD</b>	SVCIMAGEMGMT-MOB3	AddOn, Edge Service, Image Service, Mobility, 3 Year
<b>ADD</b>	SVCSPAREMGMT-MOB3	AddOn, Edge Service, Advanced Exchange, Mobility, 3 Year. Customer owned spare pool, Minimum Purchase required.
<b>PLATINUM</b>	SVCCT47-SP3N	CT47, Edge Service, PLATINUM, 2 Day Turnaround, 3 Year, New Contract

# CT47 SOFTWARE

## Device Client Pack

The Device Client Pack (DCP) includes Launcher, Enterprise Browser, BasicTE, and Mobility Web SDK, these applications are pre-loaded on the device.

All CT47 units include a 1 Year DCP Termed Pre-License for initial evaluation of the DCP applications (it does NOT include a Perpetual Pre-License), after the 1 Year Term period expires, a Perpetual or Term license is required to be purchased.

There are two licensing options that can be purchased for DCP:

1. Perpetual License Purchase DCP-001 - Perpetual Licenses operate without expiration for the authorized software version features, and includes 1 year of Maintenance. Add additional Software Maintenance separately.
2. Term + Maintenance License Purchase DCP-SFT1, DCP-SFT2, DCP-SFT3, DCP-SFT4 or DCP-SFT5 - Term + Maintenance Licenses provide software operation, software new version features, and tech support, all for a defined period.

### Device Client Pack



Launcher



Launcher - gives the customer total control over which apps can be run on the device.



BasicTE

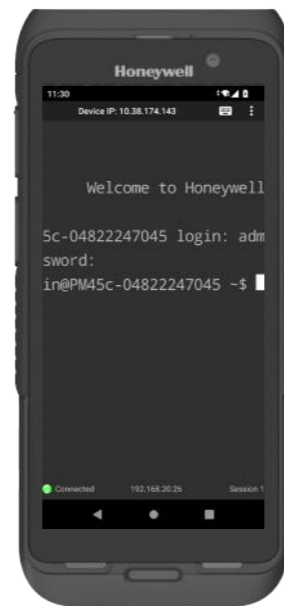

BasicTE Android device Terminal Emulation is a simplified alternative for those not yet ready to upgrade to SmartTE.



Enterprise Browser



Enterprise Browser provides corporations the ability to run standard web applications from a controlled environment.

### Order Separately



SmartTE Terminal Emulator



Terminal Emulator - Full featured SmartTE allows legacy green screen apps to be transformed to the look and feel of native apps. These clients are single session Honeywell TE Licensing. They can also utilize traditional single or multi-session StayLinked Licenses.

SmartTE is Pre-Loaded, but requires license SMARTTE-001 to be purchased separately.

PART NUMBER	DESCRIPTION
SMARTTE-001	SmartTE Single path initial license. Includes 1 Year maintenance.
SMARTTE-SFT3	SMARTTE - 3 Year Software Maintenance
SMARTTE-SFT5	SMARTTE - 5 Year Software Maintenance
SMARTTE-SND-SFT1	SMARTTE - High availability secondary backup or development server, includes 1 Year maintenance. Not for primary server. Purchase one per device.

PART NUMBER	DESCRIPTION
DCP-001	Device Client Pack Perpetual License (DCP) includes 1 Year Software Maintenance. License covers Launcher, Enterprise Browser, BasicTE, and Mobility Web SDK. Purchase additional years of Software Maintenance DCP-SFT1, DCP-SFT2, DCP-SFT3, DCP-SFT4 or DCP-SFT5 prior to maintenance expiring. Perpetual license provides continuous access to the software, but includes only one year of maintenance for updates and patches
DCP-SFT1	Device Client Pack - 1 Year Term + Maintenance (License covers Launcher, Enterprise Browser, BasicTE, and Mobility Web SDK)
DCP-SFT2	Device Client Pack - 2 Year Term + Maintenance (License covers Launcher, Enterprise Browser, BasicTE, and Mobility Web SDK)
DCP-SFT3	Device Client Pack - 3 Year Term + Maintenance (License covers Launcher, Enterprise Browser, BasicTE, and Mobility Web SDK)
DCP-SFT4	Device Client Pack - 4 Year Term + Maintenance (License covers Launcher, Enterprise Browser, BasicTE, and Mobility Web SDK)
DCP-SFT5	Device Client Pack - 5 Year Term + Maintenance (License covers Launcher, Enterprise Browser, BasicTE, and Mobility Web SDK)



# CT47 SCANNING

## Scan Handle Side by Side Comparison

Use for Scan intensive applications.

Scan Handles are not compatible with CT47 Extended Battery (CT4X-BTEC-001)



1



2



3

	PART NUMBER	DESCRIPTION
1	CT45-SH-UVN	CT45/CT45 XP/CT47 Non-Booted universal scan handle to be used with CT45/XP/CT47 without Protective Boot
2	CT4X-SH-UVB	CT45/CT47 Booted universal scan handle to be used with CT47 (Protective Boot must be ordered separately)
	CT47-PB-1	CT47 Protective Boot
3	CT4X-SH-UVB	CT45/CT47 Booted universal scan handle to be used with CT47 (Protective Boot must be ordered separately)
	CT47-PB-2	CT47 Protective Boot Hi-Visibility

# CT47 SCANNING

## Option 1 - Scan Handle

Use for Scan intensive applications, also compatible with using Rear Camera with Scan Handle installed.

This scan handle is ONLY compatible with Non-Booted charging docks.

Not compatible with CT47 Extended Battery (CT4X-BTEC-001)



Stylus



Side View



Rear View

PART NUMBER	DESCRIPTION
1	<p>CT45, CT45 XP and CT47 universal scan handle to be used with CT45/CT45 XP/ CT47 without protective boot Compatible for use with Home Base and Charge Base without removal.</p> <p>CT40-HB-0 / CT40-HB-UVN-0 Home Base CT40-CB-CNV-0 / CT40-CB-UVN-0 Quad Charge Base                      CT40-EB-0 / CT40-EB-UVN-0 Ethernet Home Base CT40-NB-CNV-0 / CT40-NB-UVN-0 Quad Net Base                      CT40-DB-0 / CT40-DB-UVN-0 Display Base</p> <p>Not Compatible with the Protective Boot Bases</p> <p>CT40-HB-UVB-0 Protective Boot Home Base                      CT40-EB-UVB-0 Protective Boot Ethernet Home Base                      CT40-DB-UVB-0 Protective Boot Display Base                      CT40-CB-PB-0 Protective Boot Quad Charge Base CT40-CB-UVB-0 Protective Boot Quad Charge Base                      CT40-NB-PB-0 Protective Boot Quad Net Base CT40-NB-UVB-0 Protective Boot Quad Net Base</p>

# CT47 SCANNING

## Option 2 - Scan Handle with Protective Boot

Use for Scan intensive applications with additional protection of the protective boot.

This scan handle is ONLY compatible with Booted charging docks.

Not compatible with CT47 Extended Battery (CT4X-BTEC-001)



PART NUMBER	DESCRIPTION	
1	CT4X-SH-UVB	CT45/CT47 Booted universal scan handle to be used with CT47 (Protective Boot must be ordered separately) Compatible for use with Protective Boot Home Base and Charge Base without removal.
		CT40-HB-UVB-0 Protective Boot Home Base
		CT40-EB-UVB-0 Protective Boot Ethernet Home Base
		CT40-DB-UVB-0 Protective Boot Display Base
		CT40-CB-PB-0 Protective Boot Quad Charge Base
		CT40-NB-PB-0 Protective Boot Quad Net Base
2	CT47-PB-1	CT47 Protective Boot
		Not Compatible with the Non-Protective Boot Bases CT40-HB-0 / CT40-HB-UVN-0 Home Base CT40-EB-0 / CT40-EB-UVN-0 Ethernet Home Base CT40-DB-0 / CT40-DB-UVN-0 Display Base CT40-CB-CNV-0 / CT40-CB-UVN-0 Quad Charge Base CT40-NB-CNV-0 / CT40-NB-UVN-0 Quad Net Base

# CT47 SCANNING

## Option 3 - Scan Handle with Protective Boot - Hi-Visibility

Use for Scan intensive applications with additional protection of the protective boot.

This scan handle is ONLY compatible with Booted charging docks.

Not compatible with CT47 Extended Battery (CT4X-BTEC-001)



PART NUMBER	DESCRIPTION	
1	CT4X-SH-UVB	CT45/CT47 Booted universal scan handle to be used with CT47 (Protective Boot must be ordered separately) Compatible for use with Protective Boot Home Base and Charge Base without removal.
		CT40-HB-UVB-0 Protective Boot Home Base
		CT40-EB-UVB-0 Protective Boot Ethernet Home Base
		CT40-DB-UVB-0 Protective Boot Display Base
		CT40-CB-PB-0 Protective Boot Quad Charge Base
		CT40-NB-PB-0 Protective Boot Quad Net Base
2	CT47-PB-2	CT47 Protective Boot Hi-Visibility
		Not Compatible with the Non-Protective Boot Bases
		CT40-HB-0 / CT40-HB-UVN-0 Home Base
		CT40-EB-0 / CT40-EB-UVN-0 Ethernet Home Base
		CT40-DB-0 / CT40-DB-UVN-0 Display Base
		CT40-CB-CNV-0 / CT40-CB-UVN-0 Quad Charge Base
	CT40-NB-CNV-0 / CT40-NB-UVN-0 Quad Net Base	

# CT47 PROTECTIVE BOOT

## Dockable Protective Boot

Use when protective boot is required with or without scan handle and dockable, compatible with handstrap installed.



CT47-PB-1 is compatible with CT47 Extended Battery (CT4X-BTEC-001)

PART NUMBER	DESCRIPTION
1 CT47-PB-1	CT47 Protective Boot

# CT47 PROTECTIVE BOOT

## Dockable Protective Boot - Hi-Visibility

Use when protective boot is required with or without scan handle and dockable, compatible with handstrap installed.



CT47-PB-2 is compatible with CT47 Extended Battery (CT4X-BTEC-001)

PART NUMBER	DESCRIPTION
1 CT47-PB-2	CT47 Protective Boot Hi-Visibility

# CT47 DESKTOP COMMUNICATIONS

## Option 1 – Portable – Non-Booted or Booted

USB Communication to PC/ Mac OR Snap-On Charging.

CT47 Non-Booted



CT47 Booted  
CT47-PB-1



**PART NUMBER**      **DESCRIPTION**

**1**      CT45-SN-CNV      CT45/CT45XP/CT47 Booted and Non-Booted Snap On adaptor. Provides tethered USB client connectivity. Compatible with hand strap, battery pack, and scan handle. Charges mobile computer battery in four hours or less. Kit includes snap-on adapter with convertible adaptor (CT45-SN-IST).

**2**      50136024-001      KIT,5V/2A PS,5 PLUGS PACKED, ROW Includes US,UK,AU,EU,IN adapters

## Option 2 – Fixed with Universal Cup

USB and optional Ethernet Communication & Single Battery Charger.

CT47 Non-Booted



CT47 Booted  
CT47-PB-1



CT40-HB-UVN-0 Home Base    CT40-EB-UVN-0 eHome Base  
CT40-HB-UVB-0 Home Base    CT40-EB-UVB-0 eHome Base



Rear View



**PART NUMBER**      **DESCRIPTION**

**1A**      CT40-HB-UVN-0      **Non-Booted** HomeBase - Kit includes (CT40-UCP-N), Dock & Power Supply, No Power Cord

**OR**      CT40-EB-UVN-0      **Non-Booted eHomeBase – Ethernet** Kit includes (CT40-UCP-N), Dock & Power Supply, No Power Cord

**1B**      CT40-HB-UVB-0      **Booted** HomeBase - Kit includes (CT40-UCP-B), Dock & Power Supply, No Power Cord

**OR**      CT40-EB-UVB-0      **Booted eHomeBase – Ethernet** Kit includes (CT40-UCP-B), Dock & Power Supply, No Power Cord

**2**      321-576-004      Cable Assembly - USB Type A to Type B

**3**      \*\*      IEC C13 AC Power Cord – See Page 63 for Country Specific Power Cords

# CT47 COMMUNICATIONS

## Option 3 – USB Type C On-The-Go (OTG) Desktop

USB C Communication to PC/ Mac OR Charging.

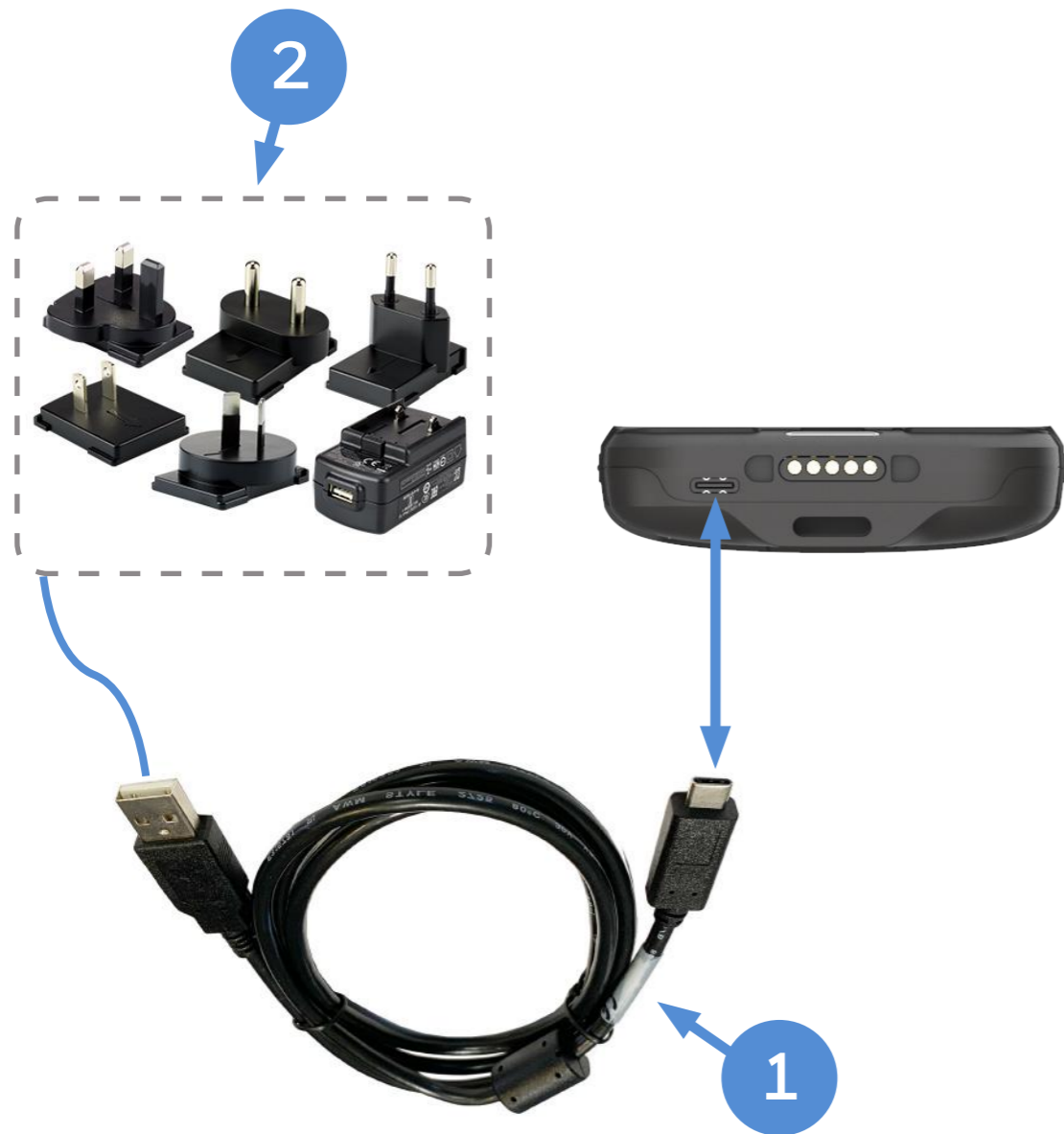

PART NUMBER	DESCRIPTION
1	CBL-500-120-S00-05 USB type A to type C, 1.2 m (3.9 ft)
2	50136024-001 KIT,5V/2A PS,5 PLUGS PACKED, ROW Includes US,UK,AU,EU,IN adapters

## Option 4 – USB Type C On-The-Go (OTG) Vehicle

USB C Communication to Vehicle OR Charging.



PART NUMBER	DESCRIPTION
1A	CBL-500-120-S00-05 USB type A to type C, 1.2 m (3.9 ft)
1B	CT45 and CT45XP Booted and Non-Booted Snap On adaptor. Provides tethered USB client connectivity. Compatible with hand strap, battery pack, and scan handle. Charges mobile computer battery in four hours or less. Kit includes snap-on adaptor with convertible adaptor (CT45-SN-IST).
2	CT45-CIGR-1 Charging CT45, CT45XP, CT40 and CT40XP configurations on vehicle. Quick Charge 3.0 compliant. Requires CT45 USB adapter (CT45-SN-CNV ) or USB cable (CBL-500-120-S00-05 ) to be ordered separately. (Converts 12 V/24 V cigarette lighter port to USB type-A power adapter for snap-on use in a vehicle)



# CT47 DESKTOP COMMUNICATIONS

## Option 5 - Display Base with Universal Cup

Connect USB peripherals (keyboard, mouse) and External Monitor via HDMI.

### Display Base supports:

- Primary Mode
- Mirror Mode
- Desktop Mode - requires additional Device Client Pack (DCP) license.



PART NUMBER	DESCRIPTION
1A CT40-DB-UVN-0	<b>Non-Booted</b> Display Dock - Kit includes (CT40-UCP-N), Display Base & Power Supply, No Power Cord
1B CT40-DB-UVB-0	<b>Booted</b> Display Dock - Kit includes (CT40-UCP-B), Display Base & Power Supply, No Power Cord
2 **	IEC C13 AC Power Cord – See Page 63 for Country Specific Power Cords

# CT47 VEHICLE INSTALL

## Option 1 – Portable/ Sub Contractor Install

Simple Vehicle Charging, portable between vehicles.

Compatible with CT47 with or without CT47-PB-1 or CT47-PB-2 Protective Boot installed.



**PART NUMBER**      **DESCRIPTION**

<b>1</b>	CT45-SN-CNV	CT45/CT45XP/CT47 Booted and Non-Booted Snap On adaptor. Provides tethered USB client connectivity. Compatible with hand strap, battery pack, and scan handle. Charges mobile computer battery in four hours or less. Kit includes snap-on adaptor with convertible adaptor (CT45-SN-IST).
<b>2</b>	CT45-CIGR-1	Charging CT47, CT45, CT45XP, CT40 and CT40XP configurations on vehicle. Quick Charge 3.0 compliant. Requires CT45 USB adapter (CT45-SN-CNV) or USB cable (CBL-500-120-S00-05) to be ordered separately. (Converts 12 V/24 V cigarette lighter port to USB type-A power adapter for snap-on use in a vehicle)

## Option 2 – Portable/ Sub Contractor Install

Windscreen Suction Cup Mount, portable between vehicles.

Compatible with CT47 with or without CT47-PB-1 or CT47-PB-2 Protective Boot installed.



Recommended Screws  
8#-32-UNC  
(Length = 0.5 inch)  
50143775-001 Pack 4 Screws

**PART NUMBER**      **DESCRIPTION**

<b>1</b>	CT45-VD-CNV	CT45/ CT45 XP/ CT47 Booted and Non-Booted Vehicle Dock. For charging CT45/XP with or without a convertible adaptor, compatible with hand strap. NFC tag integrated for seamless pairing with mobile computer. Kit includes vehicle dock (CT40-VD-CNV) with convertible adaptor (CT45-VD-IST).
<b>2</b>	RAM-B-166-202U	Suction Cup Mount Kit
<b>3</b>	50138169-001	Cigarette Lighter Power Adapter Cable

# CT47 VEHICLE INSTALL

## Option 3 - Fixed Vehicle Install with Direct Connection to Vehicle Battery

Best used when the vehicle input voltage varies, 10-30V.

Compatible with or without CT47-PB-1 or CT47-PB-2 Protective Boot installed.

Compatible with CT47 Standard Battery (CT4X-BTSC-001)

Compatible with CT47 Wireless Battery (CT4X-BTWC-001)

Not compatible with CT47 Extended Battery (CT4X-BTEC-001)



PART NUMBER	DESCRIPTION
1	CT45-VD-CNV CT45/ CT45 XP/ CT47 Booted and Non-Booted Vehicle Dock. For charging CT45/XP with or without a convertible adaptor, compatible with hand strap. NFC tag integrated for seamless pairing with mobile computer. Kit includes vehicle dock (CT40-VD-CNV) with convertible adaptor (CT45-VD-IST).
2	203-802-001 Vehicle Dock Installation Kit (Power Option: For connection of Vehicle Dock directly to vehicle battery. Includes power cables and cable mounting hardware)
3	805-611-001 Mounting Kit, V-Dock RoHS

# CT47 VEHICLE INSTALL

## Option 4 - Fixed Vehicle Install with Direct Connection to Vehicle Battery - External Speaker

Best used when the vehicle input voltage varies, 10-30V.

Compatible with or without CT47-PB-1 or CT47-PB-2 Protective Boot installed.

Compatible with CT47 Standard Battery (CT4X-BTSC-001)

Compatible with CT47 Wireless Battery (CT4X-BTWC-001)

Not compatible with CT47 Extended Battery (CT4X-BTEC-001)

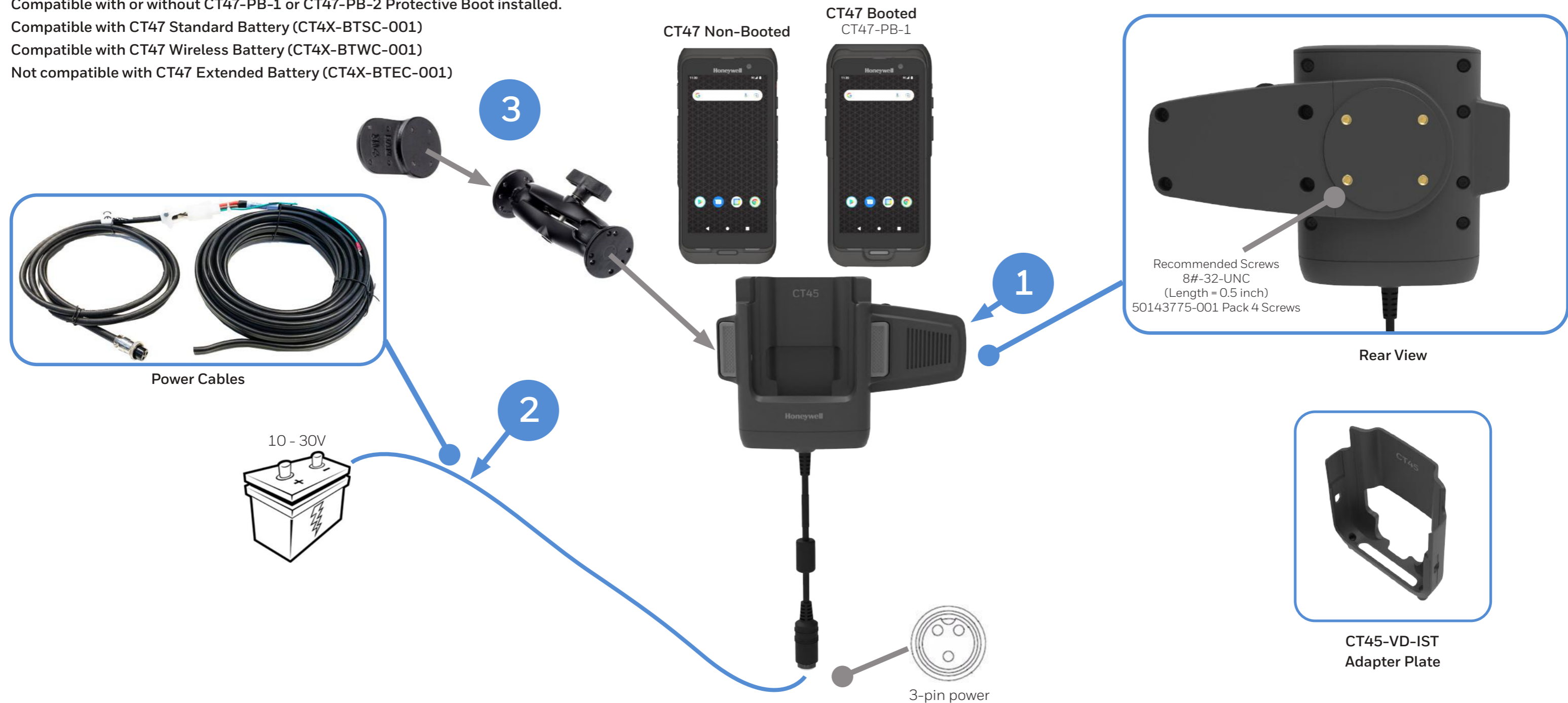

PART NUMBER	DESCRIPTION
1	CT45-VD-CNV-SPK CT45/ CT45 XP/ CT47 Booted and Non-Booted Vehicle Dock with External Speaker. For charging CT45/XP with or without a convertible adaptor, compatible with hand strap. NFC tag integrated for seamless pairing with mobile computer. Kit includes vehicle dock with convertible adaptor (CT45-VD-IST).
2	203-802-001 Vehicle Dock Installation Kit (Power Option: For connection of Vehicle Dock directly to vehicle battery. Includes power cables and cable mounting hardware)
3	805-611-001 Mounting Kit, V-Dock RoHS

# CT47 VEHICLE INSTALL

## Option 5 - Fixed Vehicle Install with Direct Connection to Vehicle Battery/ Fuse Block

Best used when the vehicle input voltage varies, 10-30V.

Compatible with or without CT47-PB-1 or CT47-PB-2 Protective Boot installed.

Compatible with CT47 Standard Battery (CT4X-BTSC-001)

Compatible with CT47 Wireless Battery (CT4X-BTWC-001)

Not compatible with CT47 Extended Battery (CT4X-BTEC-001)



	PART NUMBER	DESCRIPTION
<b>1</b>	CT45-VD-CNV	CT45/ CT45 XP/ CT47 Booted and Non-Booted Vehicle Dock. For charging CT45/XP with or without a convertible adaptor, compatible with hand strap. NFC tag integrated for seamless pairing with mobile computer. Kit includes vehicle dock (CT40-VD-CNV) with convertible adaptor (CT45-VD-IST).
<b>2</b>	226-109-003	72" (182.88 cm) Fuse block Power Cable with spade lugs and 3-pin connector
<b>OR</b>	226-109-004	22" (55.8 cm) Fuse block Power Cable with spade lugs and 3-pin connector
<b>3</b>	805-611-001	Mounting Kit, V-Dock RoHS
<b>OPTIONAL</b>	203-803-001	Vehicle Dock Fuse Block Power Kit RoHS (Provides connection to vehicle fuse block). Requires Power Cable (226-109-003 or 226-109-004).

# CT47 VEHICLE INSTALL

## Option 6 - Fixed Vehicle Install with Direct Connection to Vehicle Battery/ Fuse Block - External Speaker

Best used when the vehicle input voltage varies, 10-30V.

Compatible with or without CT47-PB-1 or CT47-PB-2 Protective Boot installed.

Compatible with CT47 Standard Battery (CT4X-BTSC-001)

Compatible with CT47 Wireless Battery (CT4X-BTWC-001)

Not compatible with CT47 Extended Battery (CT4X-BTEC-001)

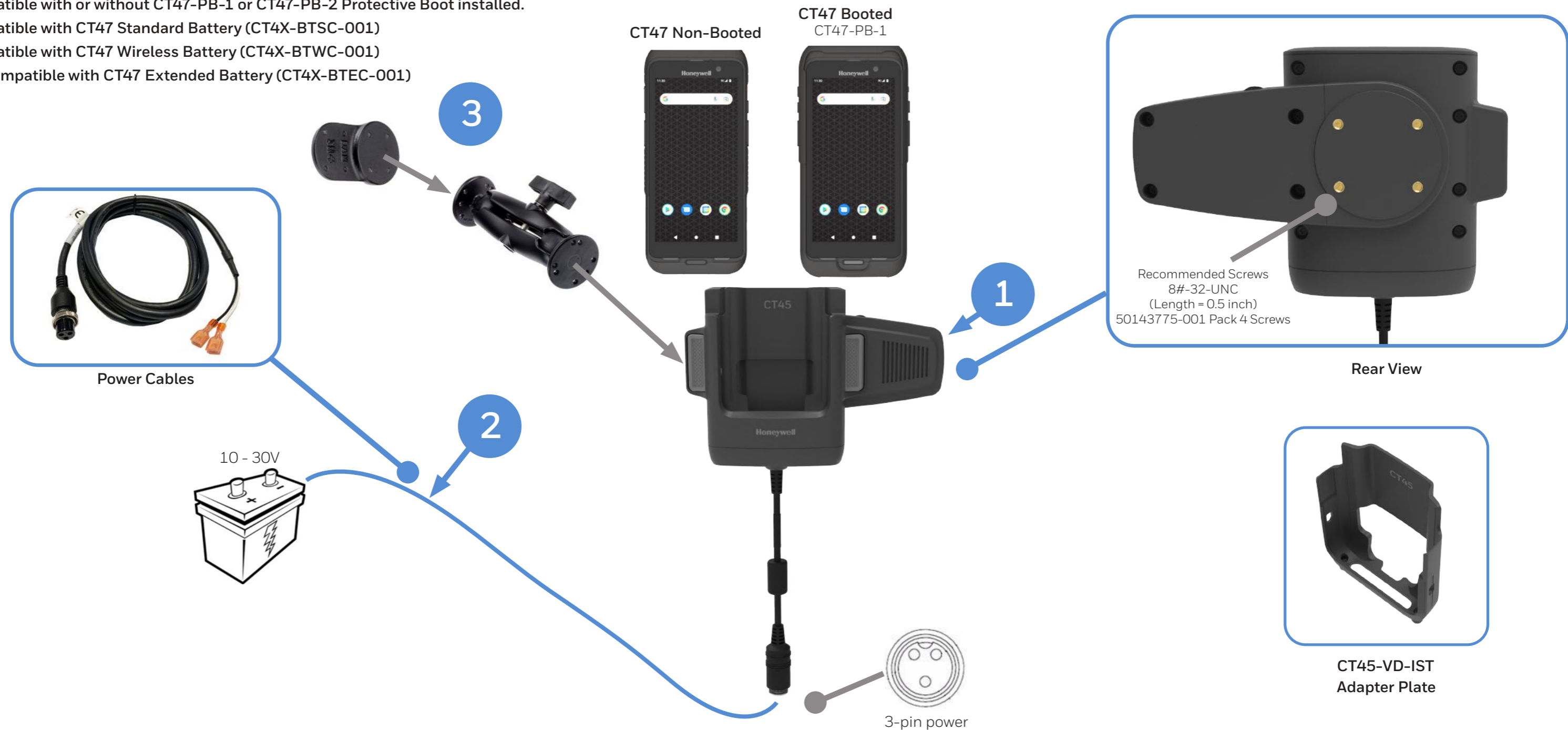

	PART NUMBER	DESCRIPTION
<b>1</b>	CT45-VD-CNV-SPK	CT45/ CT45 XP/ CT47 Booted and Non-Booted Vehicle Dock with External Speaker. For charging CT45/XP with or without a convertible adaptor, compatible with hand strap. NFC tag integrated for seamless pairing with mobile computer. Kit includes vehicle dock with convertible adaptor (CT45-VD-IST).
<b>2</b>	226-109-003	72" (182.88 cm) Fuse block Power Cable with spade lugs and 3-pin connector
<b>OR</b>	226-109-004	22" (55.8 cm) Fuse block Power Cable with spade lugs and 3-pin connector
<b>3</b>	805-611-001	Mounting Kit, V-Dock RoHS
<b>OPTIONAL</b>	203-803-001	Vehicle Dock Fuse Block Power Kit RoHS (Provides connection to vehicle fuse block). Requires Power Cable (226-109-003 or 226-109-004).

# CT47 VEHICLE INSTALL

## Option 7 - Fixed Vehicle Install with Thor DC/DC Converter

Best used when the vehicle input voltage varies, 9-60V or 50-150V.  
 Compatible with or without CT47-PB-1 or CT47-PB-2 Protective Boot installed.  
 Compatible with CT47 Standard Battery (CT4X-BTSC-001)  
 Compatible with CT47 Wireless Battery (CT4X-BTWC-001)  
 Not compatible with CT47 Extended Battery (CT4X-BTEC-001)

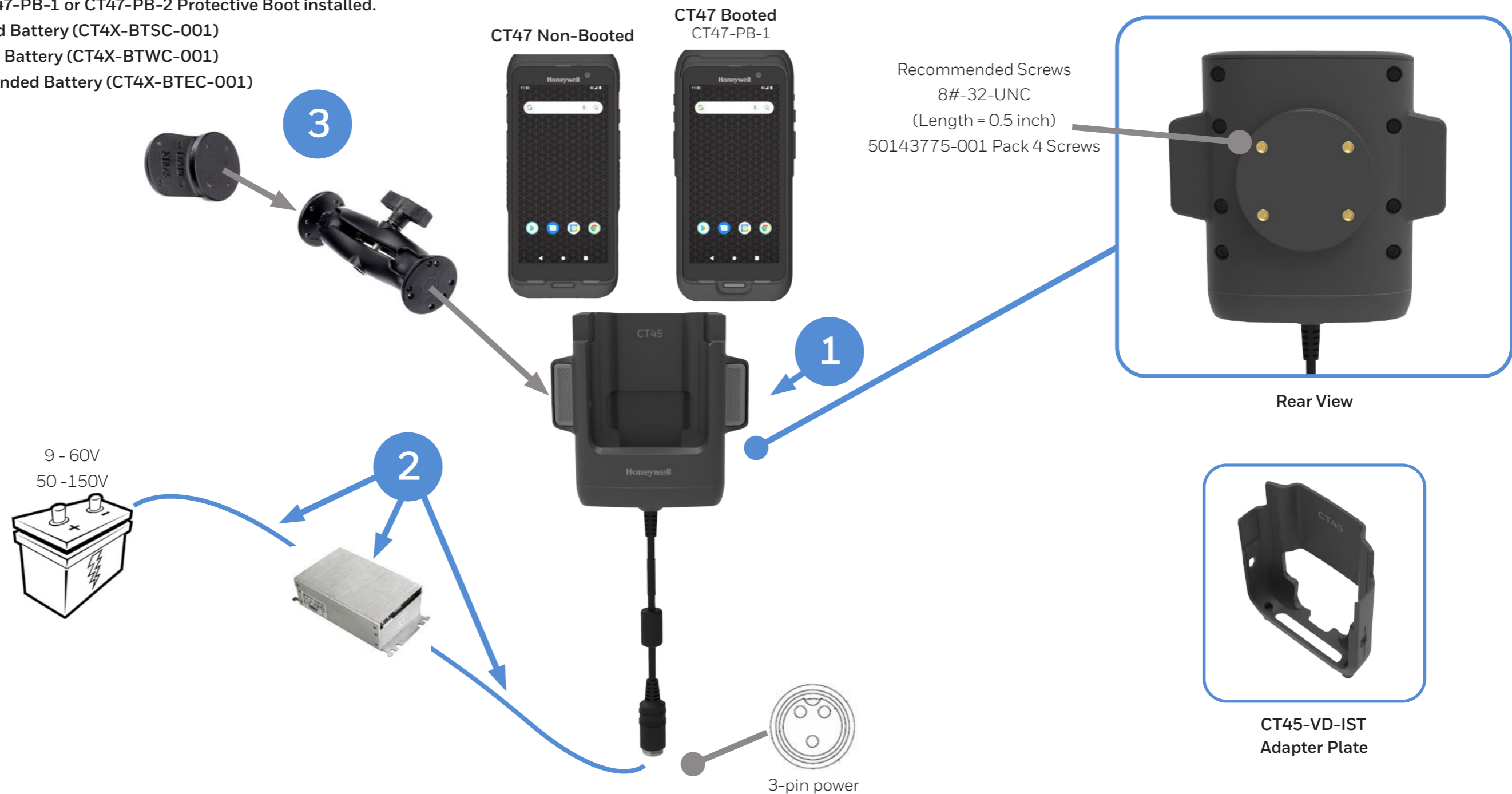

PART NUMBER	DESCRIPTION
<b>1</b> CT45-VD-CNV	CT45/ CT45 XP/ CT47 Booted and Non-Booted Vehicle Dock. For charging CT45/XP with or without a convertible adaptor, compatible with hand strap. NFC tag integrated for seamless pairing with mobile computer. Kit includes vehicle dock (CT40-VD-CNV) with convertible adaptor (CT45-VD-IST).
<b>2</b> 9000311PWRSPLY	DC/DC Converter Kit, 9-60V DC, RoHS (Requires 226-109-003 Wiring Harness)
<b>OR</b> 9000313PWRSPLY	DC/DC Converter Kit, 50-150V DC RoHS (Requires 226-109-003 Wiring Harness)
226-109-003	72" (182.88 cm) Fuse block Power Cable with spade lugs and 3-pin connector
<b>3</b> 805-611-001	Mounting Kit, V-Dock RoHS

# CT47 VEHICLE INSTALL

## Option 8 - Fixed Vehicle Install with Thor DC/DC Converter - External Speaker

Best used when the vehicle input voltage varies, 9-60V or 50-150V.

Compatible with or without CT47-PB-1 or CT47-PB-2 Protective Boot installed.

Compatible with CT47 Standard Battery (CT4X-BTSC-001)

Compatible with CT47 Wireless Battery (CT4X-BTWC-001)

Not compatible with CT47 Extended Battery (CT4X-BTEC-001)

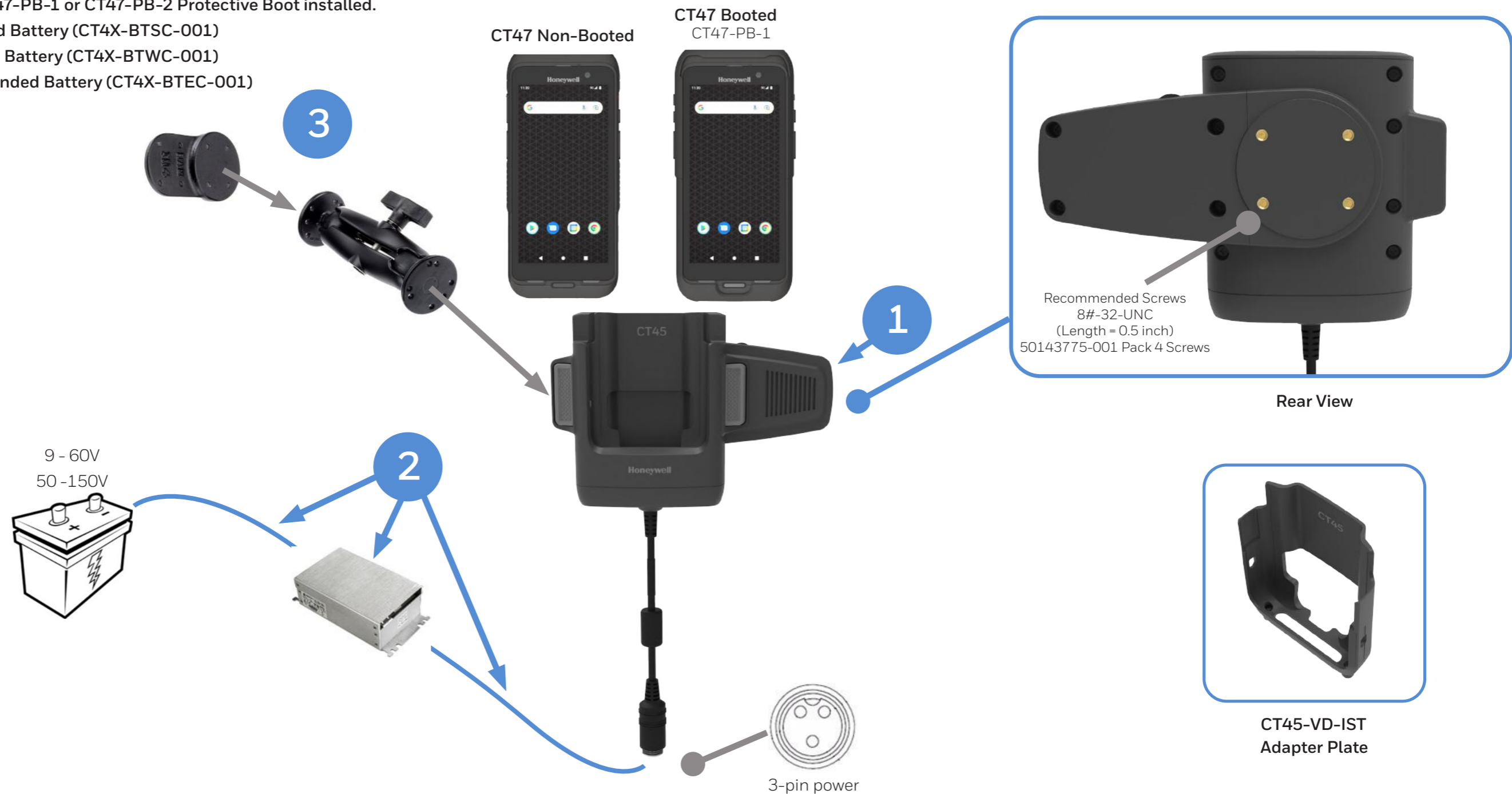

PART NUMBER	DESCRIPTION
<b>1</b> CT45-VD-CNV-SPK	CT45/ CT45 XP/ CT47 Booted and Non-Booted Vehicle Dock with External Speaker. For charging CT45/XP with or without a convertible adaptor, compatible with hand strap. NFC tag integrated for seamless pairing with mobile computer. Kit includes vehicle dock with convertible adaptor (CT45-VD-IST).
<b>2</b> 9000311PWRSPLY	DC/DC Converter Kit, 9-60V DC, RoHS (Requires 226-109-003 Wiring Harness)
<b>OR</b> 9000313PWRSPLY	DC/DC Converter Kit, 50-150V DC RoHS (Requires 226-109-003 Wiring Harness)
226-109-003	72" (182.88 cm) Fuse block Power Cable with spade lugs and 3-pin connector
<b>3</b> 805-611-001	Mounting Kit, V-Dock RoHS



# CT47 VEHICLE INSTALL

## CT45/ CT47 Vehicle Dock (CT45-VD-CNV) Detail View - Non-Booted



Insert  
CT45-VD-IST



Angle View  
Connector Detail



Angle View  
CT4X Non-Booted

Front View

Rear View

# CT47 VEHICLE INSTALL

## CT45/ CT47 Vehicle Dock (CT45-VD-CNV) Detail View - Booted



Front View



Rear View



Protective Boot  
CT47-PB-1



Angle View  
Connector Detail



Angle View  
CT4X Booted

# CT47 VEHICLE INSTALL

## CT45/ CT47 Vehicle Dock with External Speaker (CT45-VD-CNV-SPK) Detail View - Non-Booted



Front View



Rear View



Insert  
CT45-VD-IST



Angle View  
Connector Detail



Angle View  
CT4X Non-Booted

# CT47 VEHICLE INSTALL

## CT45/ CT47 Vehicle Dock with External Speaker (CT45-VD-CNV-SPK) Detail View – Booted



Protective Boot  
CT47-PB-1

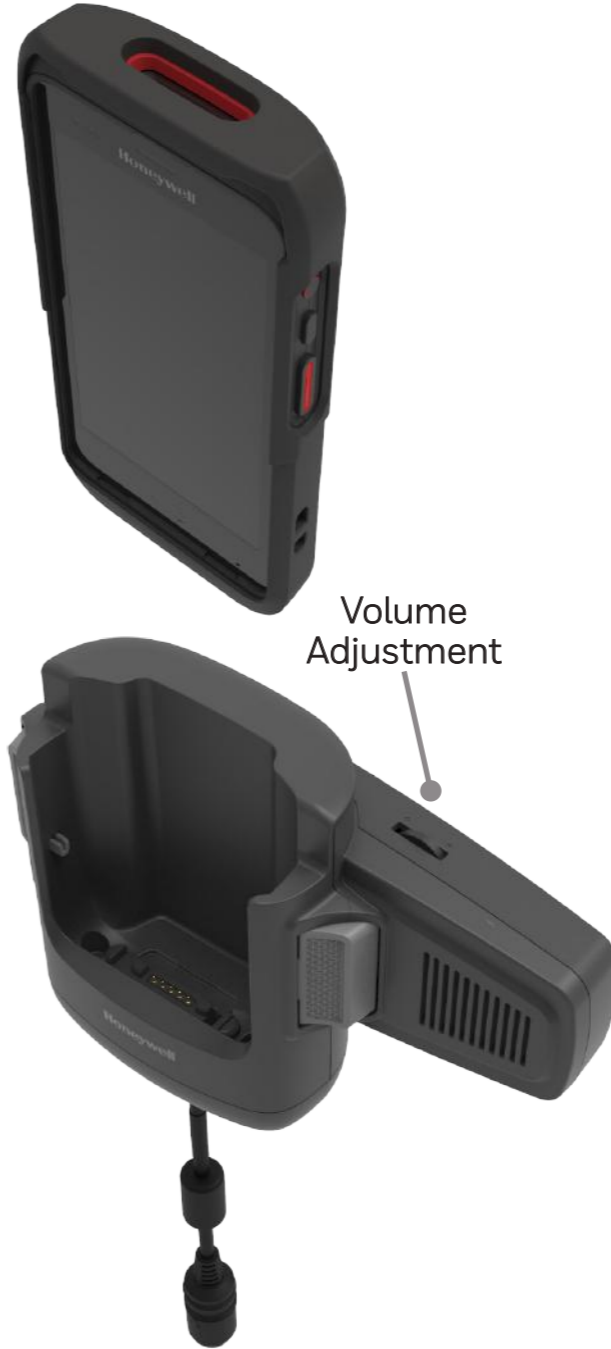

Volume Adjustment

Angle View  
Connector Detail



Angle View  
CT4X Booted

Front View

Rear View

# CT47 VEHICLE INSTALL WIRELESS CHARGING

## Option 1 - Fixed Vehicle Install with Direct Connection to Vehicle Battery

Best used when the vehicle input voltage varies, 10-30V.

Compatible with or without CT47-PB-1 or CT47-PB-2 Protective Boot installed.

Compatible with CT47 Wireless Battery (CT4X-BTWC-001)

Not compatible with CT47 Standard Battery (CT4X-BTSC-001)

Not compatible with CT47 Extended Battery (CT4X-BTEC-001)



PART NUMBER	DESCRIPTION
1 CTX-VD-CNV	CT47 Booted and Non-Booted Wireless Vehicle Dock. For charging CT47 with a Wireless Battery, compatible with hand strap. NFC tag integrated for seamless pairing with mobile computer.
2 203-802-001	Vehicle Dock Installation Kit (Power Option: For connection of Vehicle Dock directly to vehicle battery. Includes power cables and cable mounting hardware)
3 805-611-001	Mounting Kit, V-Dock RoHS

# CT47 VEHICLE INSTALL WIRELESS CHARGING

## Option 2 - Fixed Vehicle Install with Direct Connection to Vehicle Battery - External Speaker

Best used when the vehicle input voltage varies, 10-30V.

Compatible with or without CT47-PB-1 or CT47-PB-2 Protective Boot installed.

Compatible with CT47 Wireless Battery (CT4X-BTWC-001)

Not compatible with CT47 Standard Battery (CT4X-BTSC-001)

Not compatible with CT47 Extended Battery (CT4X-BTEC-001)



PART NUMBER	DESCRIPTION
1	CTX-VD-CNV-SPK CT47 Booted and Non-Booted Wireless Vehicle Dock with External Speaker. For charging CT47 with a Wireless Battery, compatible with hand strap. NFC tag integrated for seamless pairing with mobile computer.
2	203-802-001 Vehicle Dock Installation Kit (Power Option: For connection of Vehicle Dock directly to vehicle battery. Includes power cables and cable mounting hardware)
3	805-611-001 Mounting Kit, V-Dock RoHS

# CT47 VEHICLE INSTALL WIRELESS CHARGING

## Option 3 - Fixed Vehicle Install with Direct Connection to Vehicle Battery/ Fuse Block

Best used when the vehicle input voltage varies, 10-30V.

Compatible with or without CT47-PB-1 or CT47-PB-2 Protective Boot installed.

Compatible with CT47 Wireless Battery (CT4X-BTWC-001)

Not compatible with CT47 Standard Battery (CT4X-BTSC-001)

Not compatible with CT47 Extended Battery (CT4X-BTEC-001)



	PART NUMBER	DESCRIPTION
1	CTX-VD-CNV	CT47 Booted and Non-Booted Wireless Vehicle Dock. For charging CT47 with a Wireless Battery, compatible with hand strap. NFC tag integrated for seamless pairing with mobile computer.
2	226-109-003	72" (182.88 cm) Fuse block Power Cable with spade lugs and 3-pin connector
OR	226-109-004	22" (55.8 cm) Fuse block Power Cable with spade lugs and 3-pin connector
3	805-611-001	Mounting Kit, V-Dock RoHS
OPTIONAL	203-803-001	Vehicle Dock Fuse Block Power Kit RoHS (Provides connection to vehicle fuse block). Requires Power Cable (226-109-003 or 226-109-004).

# CT47 VEHICLE INSTALL WIRELESS CHARGING

## Option 4 - Fixed Vehicle Install with Direct Connection to Vehicle Battery/ Fuse Block - External Speaker

Best used when the vehicle input voltage varies, 10-30V.

Compatible with or without CT47-PB-1 or CT47-PB-2 Protective Boot installed.

Compatible with CT47 Wireless Battery (CT4X-BTWC-001)

Not compatible with CT47 Standard Battery (CT4X-BTSC-001)

Not compatible with CT47 Extended Battery (CT4X-BTEC-001)



	PART NUMBER	DESCRIPTION
<b>1</b>	CTX-VD-CNV-SPK	CT47 Booted and Non-Booted Wireless Vehicle Dock with External Speaker. For charging CT47 with a Wireless Battery, compatible with hand strap. NFC tag integrated for seamless pairing with mobile computer.
<b>2</b>	226-109-003	72" (182.88 cm) Fuse block Power Cable with spade lugs and 3-pin connector
<b>OR</b>	226-109-004	22" (55.8 cm) Fuse block Power Cable with spade lugs and 3-pin connector
<b>3</b>	805-611-001	Mounting Kit, V-Dock RoHS
<b>OPTIONAL</b>	203-803-001	Vehicle Dock Fuse Block Power Kit RoHS (Provides connection to vehicle fuse block). Requires Power Cable (226-109-003 or 226-109-004).



# CT47 VEHICLE INSTALL WIRELESS CHARGING

## Option 5 - Fixed Vehicle Install with Thor DC/DC Converter

Best used when the vehicle input voltage varies, 9-60V or 50-150V.

Compatible with or without CT47-PB-1 or CT47-PB-2 Protective Boot installed.

Compatible with CT47 Wireless Battery (CT4X-BTWC-001)

Not compatible with CT47 Standard Battery (CT4X-BTSC-001)

Not compatible with CT47 Extended Battery (CT4X-BTEC-001)



	PART NUMBER	DESCRIPTION
1	CTX-VD-CNV	CT47 Booted and Non-Booted Wireless Vehicle Dock. For charging CT47 with a Wireless Battery, compatible with hand strap. NFC tag integrated for seamless pairing with mobile computer.
2	9000311PWRSPLY	DC/DC Converter Kit, 9-60V DC, RoHS (Requires 226-109-003 Wiring Harness)
OR	9000313PWRSPLY	DC/DC Converter Kit, 50-150V DC RoHS (Requires 226-109-003 Wiring Harness)
	226-109-003	72" (182.88 cm) Fuse block Power Cable with spade lugs and 3-pin connector
3	805-611-001	Mounting Kit, V-Dock RoHS

# CT47 VEHICLE INSTALL WIRELESS CHARGING

## Option 6 - Fixed Vehicle Install with Thor DC/DC Converter - External Speaker

Best used when the vehicle input voltage varies, 9-60V or 50-150V.

Compatible with or without CT47-PB-1 or CT47-PB-2 Protective Boot installed.

Compatible with CT47 Wireless Battery (CT4X-BTWC-001)

Not compatible with CT47 Standard Battery (CT4X-BTSC-001)

Not compatible with CT47 Extended Battery (CT4X-BTEC-001)



PART NUMBER	DESCRIPTION
1	CTX-VD-CNV-SPK CT47 Booted and Non-Booted Wireless Vehicle Dock with External Speaker. For charging CT47 with a Wireless Battery, compatible with hand strap. NFC tag integrated for seamless pairing with mobile computer.
2	9000311PWRSPLY DC/DC Converter Kit, 9-60V DC, RoHS (Requires 226-109-003 Wiring Harness)
OR	9000313PWRSPLY DC/DC Converter Kit, 50-150V DC RoHS (Requires 226-109-003 Wiring Harness)
	226-109-003 72" (182.88 cm) Fuse block Power Cable with spade lugs and 3-pin connector
3	805-611-001 Mounting Kit, V-Dock RoHS

# CT47 VEHICLE INSTALL WIRELESS CHARGING

## CT47 Wireless Vehicle Dock (CTX-VD-CNV) Detail View - Non-Booted



Front View



Rear View



Insert



Angle View  
Cup Detail



Angle View  
CT47 Non-Booted



Bottom View  
Access to USB-C Port

# CT47 VEHICLE INSTALL WIRELESS CHARGING

## CT47 Wireless Vehicle Dock (CTX-VD-CNV) Detail View - Booted



Front View



Rear View



Protective Boot  
CT47-PB-1



Angle View  
Cup Detail



Angle View  
CT47 Booted



Bottom View  
Access to USB-C Port

# CT47 VEHICLE INSTALL WIRELESS CHARGING

## CT47 Wireless Vehicle Dock (CTX-VD-CNV-SPK) Detail View - Non-Booted



Front View

Rear View

Insert

Angle View  
Cup Detail

Angle View  
CT47 Non-Booted



Bottom View  
No Access

# CT47 VEHICLE INSTALL WIRELESS CHARGING

## CT47 Wireless Vehicle Dock (CTX-VD-CNV-SPK) Detail View - Booted



Front View



Rear View



Protective Boot  
CT47-PB-1



Angle View  
Cup Detail



Angle View  
CT47 Booted



Bottom View  
No Access

# CT47 VEHICLE INSTALL NON-POWERED HOLDER

## Option 1- Fixed Non-Powered Vehicle Holder with Non-Booted Scan Handle

Compatible with CT47 Non-Booted Scan Handle CT45-SH-UVN installed.



Side View



Rear View



Rear View - Non-Booted Scan Handle Installed

PART NUMBER	DESCRIPTION
1 CT45-VH-SH	CT45/CT47 Vehicle Holder compatible with Booted or Non-Booted scan handle.
2 805-611-001	Mounting Kit, V-Dock RoHS

# CT47 VEHICLE INSTALL NON-POWERED HOLDER

## Option 2 - Fixed Non-Powered Vehicle Holder with Booted Scan Handle

Compatible with CT47 Booted Scan Handle CT4X-SH-UVB and CT47-PB-1 or CT47-PB-2 Protective Boot installed.



Side View



Rear View



Rear View - Booted Scan Handle Installed

PART NUMBER	DESCRIPTION
1 CT45-VH-SH	CT45/CT47 Vehicle Holder compatible with Booted or Non-Booted scan handle.
2 805-611-001	Mounting Kit, V-Dock RoHS



# CT47 CHARGING AND COMMUNICATION

## Option 1 - Non-Booted Quad Charger with Universal Cup

Chargebase – Quad Dock Charge Only  
 Netbase – Quad Dock with Ethernet  
 Not Compatible with CT47-PB-1 Protective Boot



Kit Includes:  
 4 x CT40-UCP-N  
 CT40 / CT45 / CT47 Cup for Non-Booted

## Option 2 - Booted Quad Charger with Universal Cup

Chargebase – Quad Dock Charge Only  
 Netbase – Quad Dock with Ethernet  
 Compatible with CT47-PB-1 Protective Boot



Kit Includes:  
 4 x CT40-UCP-B  
 CT40 / CT45 / CT47 Cup for Booted

	PART NUMBER	DESCRIPTION
1	CT40-CB-UVN-0	<b>Non-Booted</b> Chargebase - Kit includes Dock and Power Supply
OR	CT40-NB-UVN-0	<b>Non-Booted</b> Netbase - For Ethernet comms, Kit includes Dock and Power Supply
2	**	IEC C13 AC Power Cord – See Page 63 for Country Specific Power Cords

	PART NUMBER	DESCRIPTION
1	CT40-CB-UVB-0	<b>Booted</b> Chargebase - Kit includes Dock and Power Supply
OR	CT40-NB-UVB-0	<b>Booted</b> Netbase - For Ethernet comms, Kit includes Dock and Power Supply
2	**	IEC C13 AC Power Cord – See Page 63 for Country Specific Power Cords

# CT47 CHARGING AND COMMUNICATION

## Option 3 - Non-Booted 5-Bay Charger with Battery Cup

Chargebase – Quad Dock Charge Only (4 terminals) and Quad Battery Charger (4 Batteries)  
 Netbase – Quad Dock Ethernet (4 terminals) and Quad Battery Charger (4 Batteries)  
 Not Compatible with CT47-PB-1 Protective Boot  
 Compatible with Scan Handle



Top View with Scan Handle installed



Kit Includes:  
 4 x CT40-UCP-N  
 CT40 / CT45 / CT47 Cup for Non-Booted

## Option 4 - Booted 5-Bay Charger with Battery Cup

Chargebase – Quad Dock Charge Only (4 terminals) and Quad Battery Charger (4 Batteries)  
 Netbase – Quad Dock Ethernet (4 terminals) and Quad Battery Charger (4 Batteries)  
 Compatible with CT47-PB-1 Protective Boot  
 Compatible with Scan Handle



Top View with Scan Handle installed



Kit Includes:  
 4 x CT40-UCP-B  
 CT40 / CT45 / CT47 Cup for Booted

**PART NUMBER DESCRIPTION**

<b>1</b>	CT45-5CB-UVN-BAT-0	CT45 <b>Non-Booted</b> 5 bay Universal Dock, charge up to 4 pieces of CT45/CT40/CT45XP/CT40XP/CT47 and 4 pieces of CT4x batteries. Kit includes 5 bay Universal Dock and Power Adaptor. IEC C5 Power cord must be ordered separately.
<b>OR</b>	CT47-5NB-UVN-BAT-0	CT47 <b>Non-Booted</b> 5 bay Ethernet Universal Dock, for charging up to 4 pieces of CT47 and 4 pieces of CT47 batteries. Kit includes 1 piece of 5 bay Universal NetBase, 4 pieces of CT45/CT47 cups, 1 piece of CT47 battery cup and Power Adapter. IEC C5 Power cord must be ordered separately.
<b>2</b>	**	IEC C5 AC Power Cord – See Page 63 for Country Specific Power Cords

**PART NUMBER DESCRIPTION**

<b>1</b>	CT45-5CB-UVB-BAT-0	CT45 <b>Booted</b> 5 bay Universal Dock, charge up to 4 pieces of CT45/CT40/CT45XP/CT40XP/CT47 and 4 pieces of CT4x batteries. Kit includes 5 bay Universal Dock and Power Adaptor. IEC C5 Power cord must be ordered separately.
<b>OR</b>	CT47-5NB-UVB-BAT-0	CT47 <b>Booted</b> 5 bay Ethernet Universal Dock, for charging up to 4 pieces of CT47 and 4 pieces of CT47 batteries. Kit includes 1 piece of 5 bay Universal NetBase, 4 pieces of CT45/CT47 cups, 1 piece of CT47 battery cup and Power Adapter. IEC C5 Power cord must be ordered separately.
<b>2</b>	**	IEC C5 AC Power Cord – See Page 63 for Country Specific Power Cords

# CT47 CHARGING AND COMMUNICATION

## Option 5 - Non-Booted 5-Bay Charger with Universal Cups

Chargebase – 5-Bay Dock Charge Only (5 terminals)  
 Netbase – 5-Bay Dock with Ethernet  
 Not Compatible with CT47-PB-1 Protective Boot  
 Compatible with Scan Handle



Top View with Scan Handle installed



Kit Includes:  
 4 x CT40-UCP-N  
 CT40 / CT45 / CT47 Cup for Non-Booted

## Option 6 - Booted 5-Bay Charger with Universal Cups

Chargebase – 5-Bay Dock Charge Only (5 terminals)  
 Netbase – 5-Bay Dock with Ethernet  
 Compatible with CT47-PB-1 Protective Boot  
 Compatible with Scan Handle



Top View with Scan Handle installed



Kit Includes:  
 4 x CT40-UCP-B  
 CT40 / CT45 / CT47 Cup for Booted

**PART NUMBER DESCRIPTION**

<b>1</b>	CT45-5CB-UVN-0	CT45 <b>Non-Booted</b> 5 bay Universal Dock, charge up to 5 pieces of CT45/CT40/CT45XP/CT40XP or CT47. Kit includes 5 bay Universal Dock and Power Adaptor. IEC C5 Power cord must be ordered separately.
<b>OR</b>	CT47-5NB-UVN-0	CT47 <b>Non-Booted</b> 5 bay Ethernet Universal Dock, for charging up to 5 pieces of CT47. Kit includes 1 piece of 5 bay Universal NetBase, 5 pieces of CT45/CT47 cups and Power Adapter. IEC C5 Power cord must be ordered separately.
<b>2</b>	**	IEC C5 AC Power Cord – See Page 63 for Country Specific Power Cords

**PART NUMBER DESCRIPTION**

<b>1</b>	CT45-5CB-UVB-0	CT45 <b>Booted</b> 5 bay Universal Dock, charge up to 5 pieces of CT45/CT40/CT45XP/CT40XP or CT47. Kit includes 5 bay Universal Dock and Power Adaptor. IEC C5 Power cord must be ordered separately.
<b>OR</b>	CT47-5NB-UVB-0	CT47 <b>Booted</b> 5 bay Ethernet Universal Dock, for charging up to 5 pieces of CT47. Kit includes 1 piece of 5 bay Universal NetBase, 5 pieces of CT45/CT47 cups and Power Adapter. IEC C5 Power cord must be ordered separately.
<b>2</b>	**	IEC C5 AC Power Cord – See Page 63 for Country Specific Power Cords

# CT47 CHARGING AND COMMUNICATION

## Option 7 - Quad Battery Charger

Charge up to 4 batteries simultaneously

- Supports Batteries:
- 318-055-010 - Battery, Standard, CT40 Gen 1 (4090mAh)
  - 318-055-011 - Battery, Standard, CT40 Gen 1 (4040mAh)
  - 318-055-014 - Battery, Standard, CT40 Gen 2 (4090mAh)
  - 318-055-015 - Battery, Standard, CT40 Gen 2 (4020mAh)
  - 318-055-017 - Battery, Standard, CT40 Healthcare (4020mAh)
  - 318-055-067 - Battery, Standard, CT40 Gen 2 / XP, CT45 / XP (4020mAh)
  - 318-055-D67 - Battery, Standard, CT40 DRH / XP (4020mAh)
  - 318-055-H67 - Battery, Standard, CT40 Healthcare / XP (4020mAh)
  - CT4X-BTSC-001 - Battery, Standard, CT45 / CT47, 4775mAh
  - CT4X-BTEC-001 - Battery, Extended, CT47, 7692mAh
  - CT4X-BTWC-001 - Battery, Wireless, CT45 / CT47, 4680mAh
  - CT4X-BTNA-001 - Battery, NI / ATEX / IEC Ex, CT47, 4775mAh

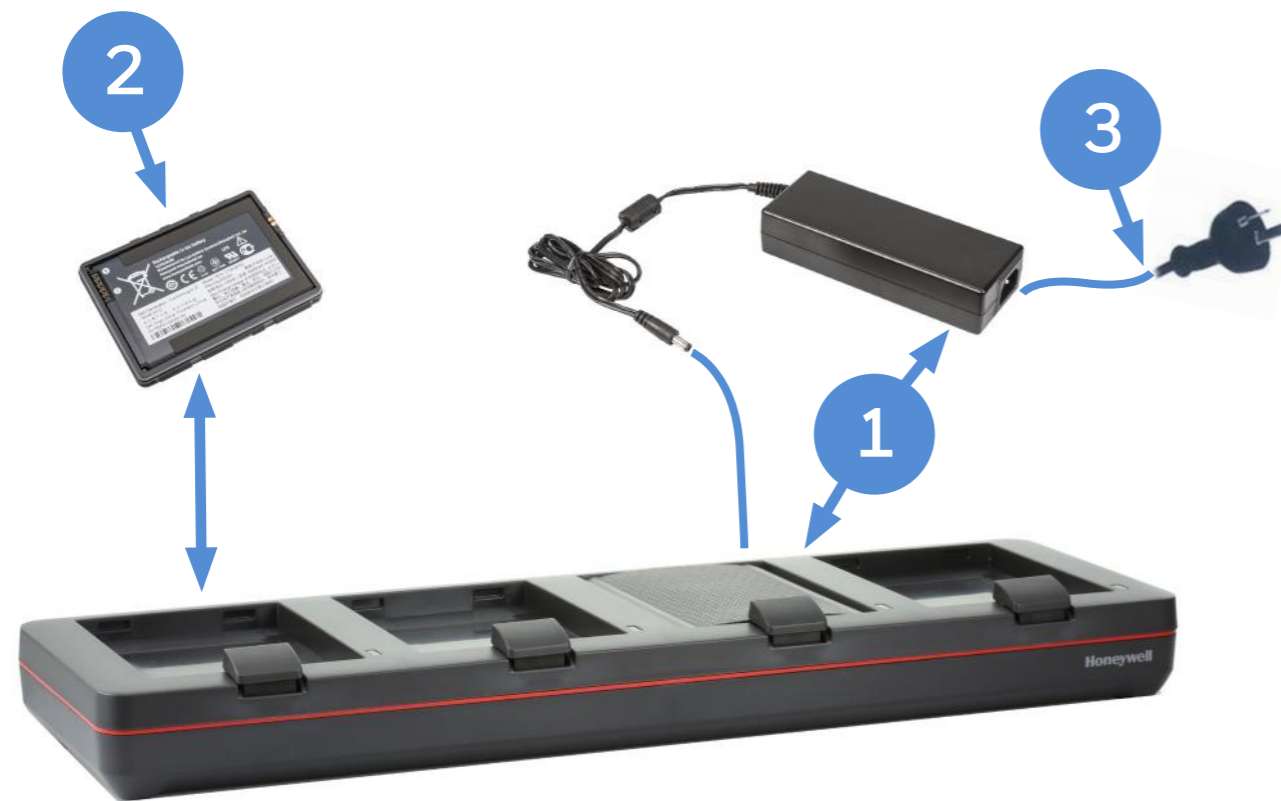

Batteries not included.

	PART NUMBER	DESCRIPTION
1	CT40-QBC-0	Quad Battery Charger - Kit includes Dock and Power Supply
2	**	Spare Battery - See Page 53 for Battery Selection
3	**	IEC C13 AC Power Cord - See Page 63 for Country Specific Power Cords

## Option 8 - 1-Bay Quad Battery Charger with Universal Cup

Charge up to 4 batteries simultaneously

- Supports Batteries:
- 318-055-010 - Battery, Standard, CT40 Gen 1 (4090mAh)
  - 318-055-011 - Battery, Standard, CT40 Gen 1 (4040mAh)
  - 318-055-014 - Battery, Standard, CT40 Gen 2 (4090mAh)
  - 318-055-015 - Battery, Standard, CT40 Gen 2 (4020mAh)
  - 318-055-017 - Battery, Standard, CT40 Healthcare (4020mAh)
  - 318-055-067 - Battery, Standard, CT40 Gen 2 / XP, CT45 / XP (4020mAh)
  - 318-055-D67 - Battery, Standard, CT40 DRH / XP (4020mAh)
  - 318-055-H67 - Battery, Standard, CT40 Healthcare / XP (4020mAh)
  - CT4X-BTSC-001 - Battery, Standard, CT45 / CT47, 4775mAh
  - CT4X-BTEC-001 - Battery, Extended, CT47, 7692mAh
  - CT4X-BTWC-001 - Battery, Wireless, CT45 / CT47, 4680mAh
  - CT4X-BTNA-001 - Battery, NI / ATEX / IEC Ex, CT47, 4775mAh

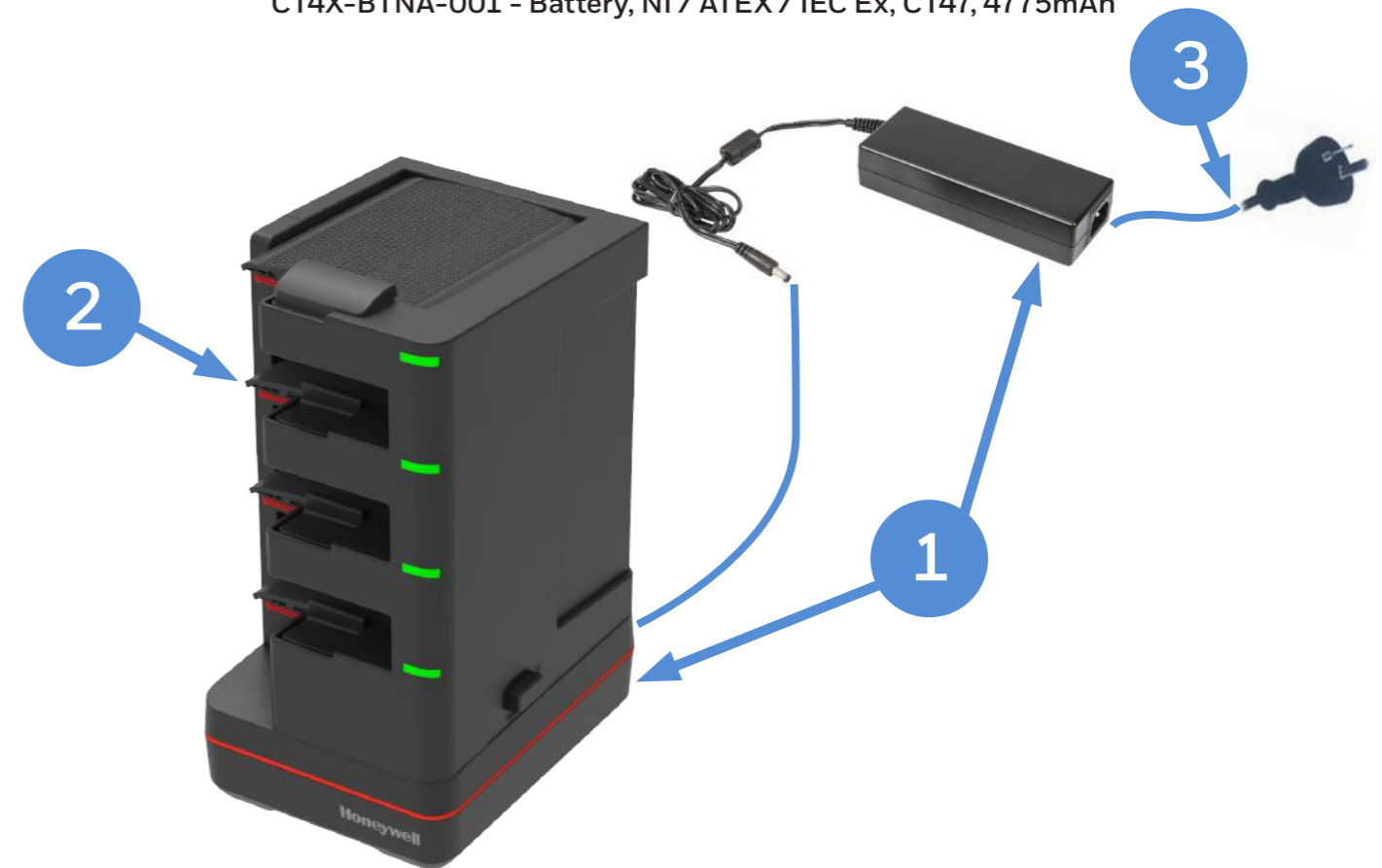

Batteries not included.

	PART NUMBER	DESCRIPTION
1	CT4X-QBC-1BAY-0	1-Bay Quad Battery Charger - Kit includes Dock and Power Supply
2	**	Spare Battery - See Page 53 for Battery Selection
3	**	IEC C13 AC Power Cord - See Page 63 for Country Specific Power Cords

# CT47 CHARGING AND COMMUNICATION

## Rack / Wall Mount Bracket

The Rack/Wall Mount Bracket has been optimized to work on a standard 19-inch (48cm) rack, as well as mounting directly onto a wall. Compatible with all 4-bay chargers.

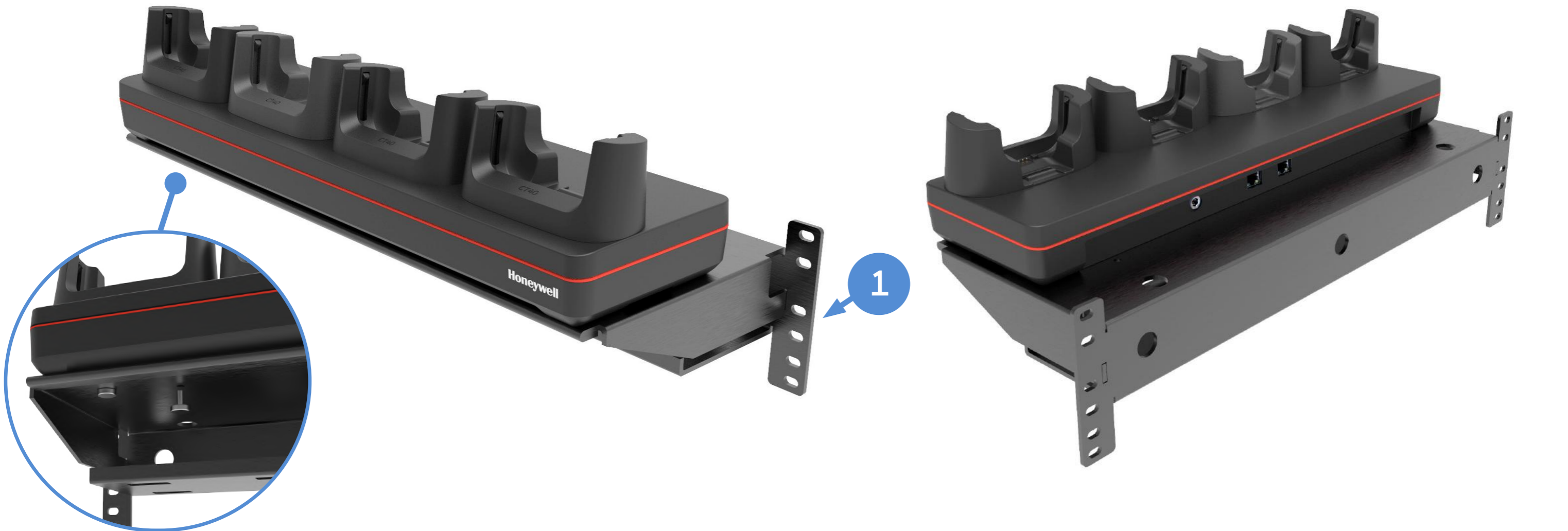

Thumb Screws View



Front View



Rear View



Power Supply Shelf View



Bottom View

	PART NUMBER	DESCRIPTION
1	CB-BK-01	4 Bay Charger Bracket, Rack / Wall Mount (includes 4 x 50180100-001 Thumb Screws M3.5x10 to securely attach the 4-bay dock to the bracket)

# CT47 BATTERY

## Spare Battery Options



**CT47 Standard Battery**  
CT47-xxx-xxxxx0x



**CT47 Extended Battery**  
CT47-xxx-xxxxx0x



**CT47 Wireless Battery**  
CT47-xxx-xxxxx0x



**CT47 NI / ATEX / IEC Ex**  
CT47-xxx-xxxxx1x

	PART NUMBER	DESCRIPTION
1	CT4X-BTSC-001	CT45 / CT47 Standard Battery Pack, 4,775mAh
2	CT4X-BTEC-001	CT47 Extended Battery Pack, 7,692mAh
3	CT4X-BTWC-001	CT45 / CT47 Wireless Battery Pack, 4,680mAh
4	CT4X-BTNA-001	CT47 NI / ATEX / IEC Ex Battery Pack, 4,775mAh

# CT47 RFID

## IH45 RFID Reader with CT47 Non-Booted

Connect the IH45 to the CT47 via Bluetooth or USB.

IH45 has a user accessible replaceable battery.



	PART NUMBER	REGION	DESCRIPTION
<b>1</b>	IH45-0-N001S00UK	FCC / ANZ	IH45 High-Performance UHF RFID tag reader, US Frequency Range of RFID output (902-928MHz), Includes Battery
<b>OR</b>	IH45-0-N001S000K	ETSI	IH45 High-Performance UHF RFID tag reader, EU Frequency Range of RFID output (865-868 MHz), Includes Battery
<b>2</b>	IH45-BK-47S		CT47 Non-Booted RFID bracket with 4 screws for IH45, IH40 and IH25, hand strap compatible
<b>3</b>	50155100-001		IH45, IH40 and IH25 Wrist Strap

### Honeywell Repair Services

SVCIH45-SG3N

IH45, Edge Service, Gold Maintenance Contract, 3 Year, New Contract

# CT47 RFID

## IH45 RFID Reader with CT47 Booted

Connect the IH45 to the CT47 via Bluetooth or USB.  
IH45 has a user accessible replaceable battery.



IH45 Front View



IH45 Rear View



IH45 Top View

	PART NUMBER	REGION	DESCRIPTION
<b>1</b>	IH45-0-N001S00UK	FCC / ANZ	IH45 High-Performance UHF RFID tag reader, US Frequency Range of RFID output (902-928MHz), Includes Battery
<b>OR</b>	IH45-0-N001S000K	ETSI	IH45 High-Performance UHF RFID tag reader, EU Frequency Range of RFID output (865-868 MHz), Includes Battery
<b>2</b>	IH45-BK-47PBS		CT47 Booted RFID bracket with 4 screws for IH45, IH40 and IH25, hand strap compatible
<b>3</b>	CT47-PB-1		CT47 Hard Protective Boot
<b>OR</b>	CT47-PB-2		CT47 Protective Boot Hi-Visibility
<b>4</b>	50155100-001		IH45, IH40 and IH25 Wrist Strap

### Honeywell Repair Services

SVCIH45-SG3N

IH45, Edge Service, Gold Maintenance Contract, 3 Year, New Contract



# CT47 RFID CHARGING

## Option 1 - IH45 Non-Booted Quad Charge

IH45 shares the same chargers as CT40/ CT45/ CT47.



Kit Includes:  
4 x CT40-UCP-N  
CT40 / CT45/ CT47 Cup for Non-Booted

## Option 2 - IH45 Booted Quad Charger

IH45 shares the same chargers as CT40/ CT45/ CT47.

When using CT40 Booted chargers, the adapter sleeve is required to fit the IH45.

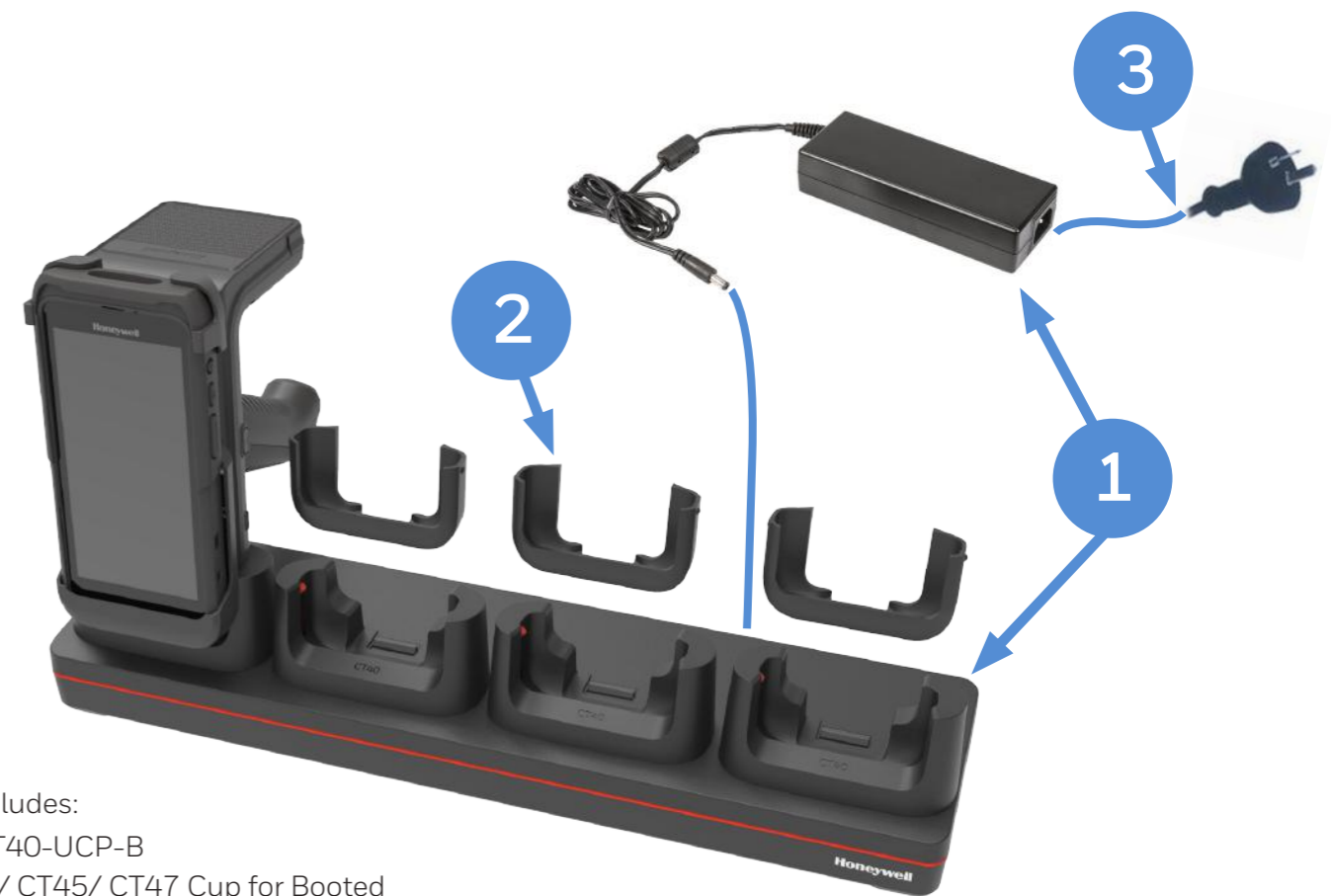

Kit Includes:  
4 x CT40-UCP-B  
CT40 / CT45/ CT47 Cup for Booted

	PART NUMBER	DESCRIPTION
1	CT40-CB-UVN-0	<b>Non-Booted</b> Chargebase - Kit includes Dock and Power Supply
OR	CT40-NB-UVN-0	<b>Non-Booted</b> Netbase - For Ethernet comms, Kit includes Dock and Power Supply
2	**	IEC C13 AC Power Cord – See Page 63 for Country Specific Power Cords

	PART NUMBER	DESCRIPTION
1	CT40-CB-UVB-0	<b>Booted</b> Chargebase - Kit includes Dock and Power Supply
OR	CT40-NB-UVB-0	<b>Booted</b> Netbase - For Ethernet comms, Kit includes Dock and Power Supply
2	IH40-ADP-SLV	IH40 Adapter Sleeve for <b>Booted</b> CT40 cup (CT40-UCP-B) - Order 4 adapters per Charge Base
3	**	IEC C13 AC Power Cord – See Page 63 for Country Specific Power Cords

# CT47 RFID

## Option 3 - IH45 Quad Battery Charger

IH45 shares the same chargers as EDA50/ EDA51 battery charger.

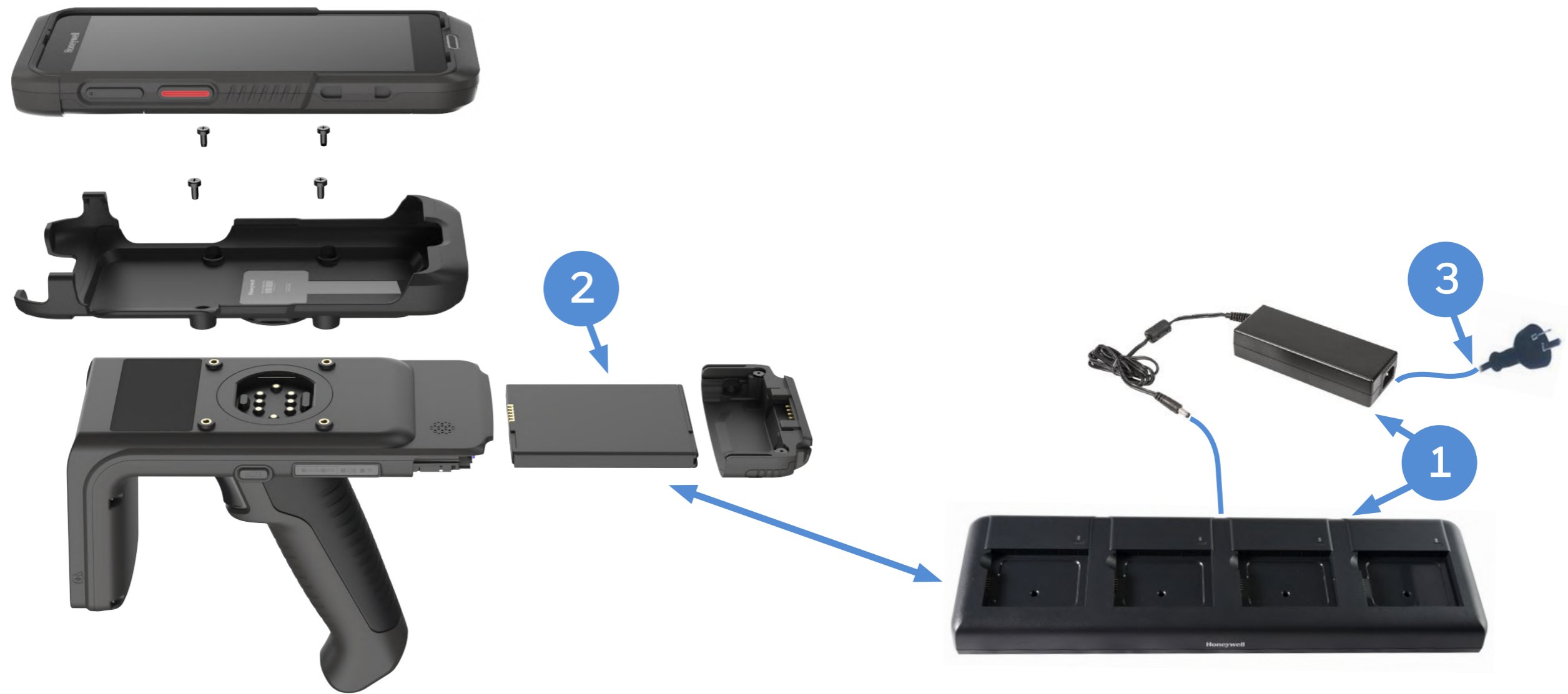

IH45 Quad Battery Charger

PART NUMBER	DESCRIPTION
1 EDA50-QBC-0	Kit IH25/IH40/EDA50/EDA70/EDA71 Quad Battery Charger. Kit includes Dock, Power Supply, No Power Cord.
2 50129589-001	Accessory, Battery (3.8V, 4,000mAh),EDA50/51/70/71
3 **	IEC C13 AC Power Cord – See Page 63 for Country Specific Power Cords

# CT47 HEADSET

## USB-C CT47 Push To Talk (PTT) Headset

USB-C audio PTT and VoIP ready to support In-Store Communication with leading 3rd party applications.  
Compatible with CT47-PB-1 Boot installed.



PART NUMBER	DESCRIPTION
1 MBL-HDST-USBC	Headset with PTT, USB C

# MISCELLANEOUS

## Optional Parts

Note: CT47-HS-3PK is replaced by CT47-HS-3PK-2



PART NUMBER	DESCRIPTION
CT47-HS-3PK-2	CT47 HAND STRAP, pack of 3



PART NUMBER	DESCRIPTION
CT45-HS-FM	CT45 HAND STRAP for Field Mobility 3 pieces per pack. Larger handstrap for field mobility workers with big hands or those who wear gloves. Compatible with Vehicle Docks.



PART NUMBER	DESCRIPTION
CT47-HS-FM	CT47 HAND STRAP for <b>Extended Battery</b> pack, 3 pieces per pack. Longer in length to support the extended battery pack.

Note: CT47-SP-1PK is replaced by CT47-SP-1PK-1



PART NUMBER	DESCRIPTION
CT40-STL-1PKC	CT40, CT45, CT47 Syllus for use with or without screen protectors. Pack of 1.



PART NUMBER	DESCRIPTION
CT47-SP-1PK-1	CT47 Screen Protector (Gorilla Glass 5), 1 Pack

# MISCELLANEOUS

## Optional Parts



PART NUMBER	DESCRIPTION
CT40-UCP-N	CT40 <b>Non-Booted</b> universal cup, to be used for CT40 without protective boot



PART NUMBER	DESCRIPTION
CT40-UCP-B	CT40 <b>Booted</b> universal cup, to be used for CT40 with protective boot (CT45-PB-1)



PART NUMBER	DESCRIPTION
CT45-VD-IST	CT45 Vehicle dock plastic insert, can be used along with CT40-VD-CNV and CT45-VD-CNV



Batteries not included.

PART NUMBER	DESCRIPTION
CT45-BAT-CUP	CT45/CT40 Universal Battery Cup Compatible CT45-5CB-UVN-BAT-0, CT45-5CB-UVB-BAT-0 and CT4X-QBC-1BAY-0

# MISCELLANEOUS

## Optional Parts



PART NUMBER	DESCRIPTION
CT50-CC-12	CHARGING CABINET FOR CT40/CT50/CT60 with space to house 12 Computers and 12 Spare Batteries. Quad battery chargers (CT40-QBC-0) and Quad ChargeBase (CT40-CB-0)



PART NUMBER	DESCRIPTION
825-239-001	HOLSTER,SCAN HANDLE, CT4X, CT50, CT60 and CT60 XP



PART NUMBER	DESCRIPTION
50175391-001	CT45/ CT47 Wrist lanyard used on scan handle, compatible with Booted or Non-Booted scan handles, Pack of 1.



PART NUMBER	DESCRIPTION
825-237-001	POUCH, CT40/CT50/CT60/CT60 XP



PART NUMBER	DESCRIPTION
CT45-HST-CP	CT4x/CT60/CT60XP/EDA5x padded holster with hook and loop front flap, bottom grommet, stylus holder and metal slide clip. (Holster is also compatible with Protective Boot on CT4x units)



PART NUMBER	DESCRIPTION
825-238-001	CT40/CT50/CT60/CT60 XP Holster

# MISCELLANEOUS

## Optional Parts

Replacement Power Supplies.



IEC C14

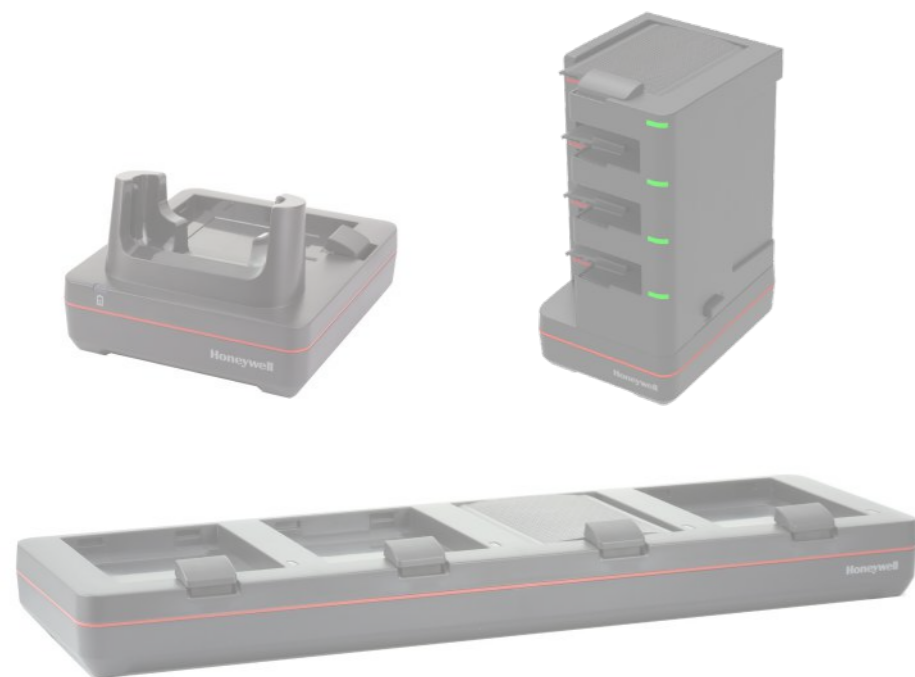

**PART NUMBER DESCRIPTION**

50121666-001 Power Adapter, 12V 3A, No Power Cord, Compatible with CT40 Homebase / eHomebase / Quad Battery Charger (Requires IEC C13 AC Power Cord)



IEC C14

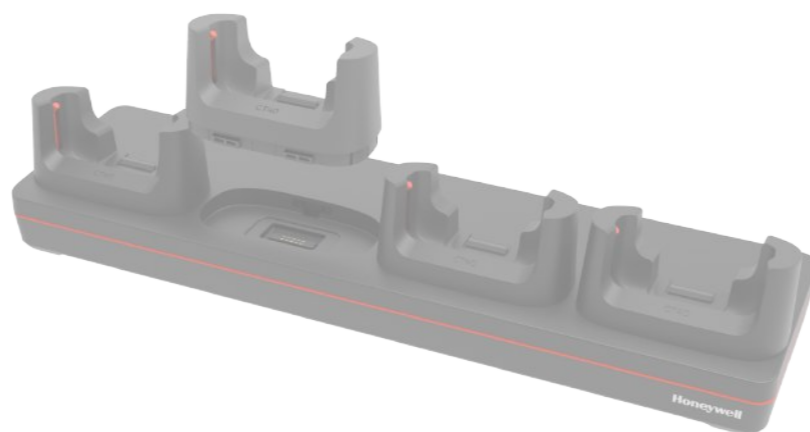

**PART NUMBER DESCRIPTION**

50121667-001 Power Adapter, 12V 7A, No Power Cord, CT40 Quad Chargebase/Quad Netbase (Requires IEC C13 AC Power Cord)



IEC C6

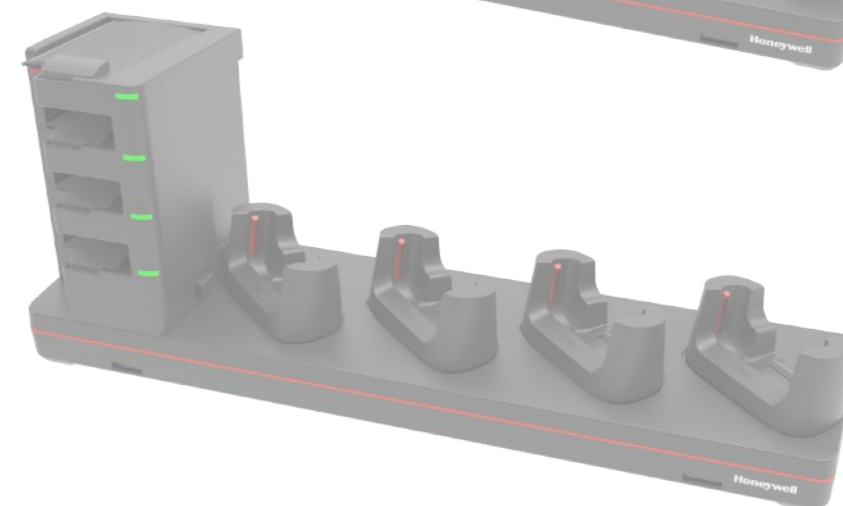
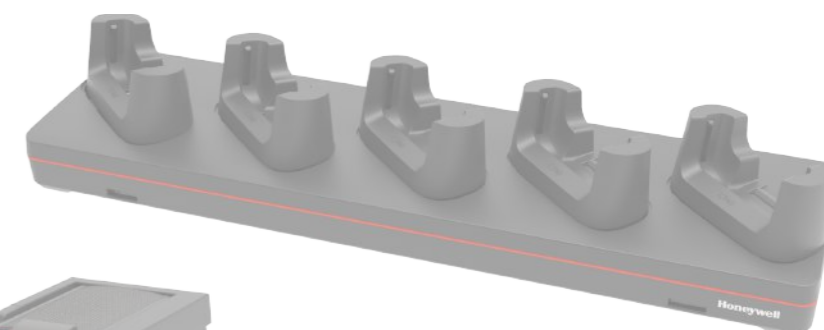

**PART NUMBER DESCRIPTION**

3007-3408-001 Power Supply 12V 8.3A R7B ADS-120QL-12-3 120100E 5-Bay Charge Base (Requires IEC C5 AC Power Cord)

# MISCELLANEOUS

## Micro-SD Cards

Honeywell Recommended – ATP Industrial Grade Micro SD Cards

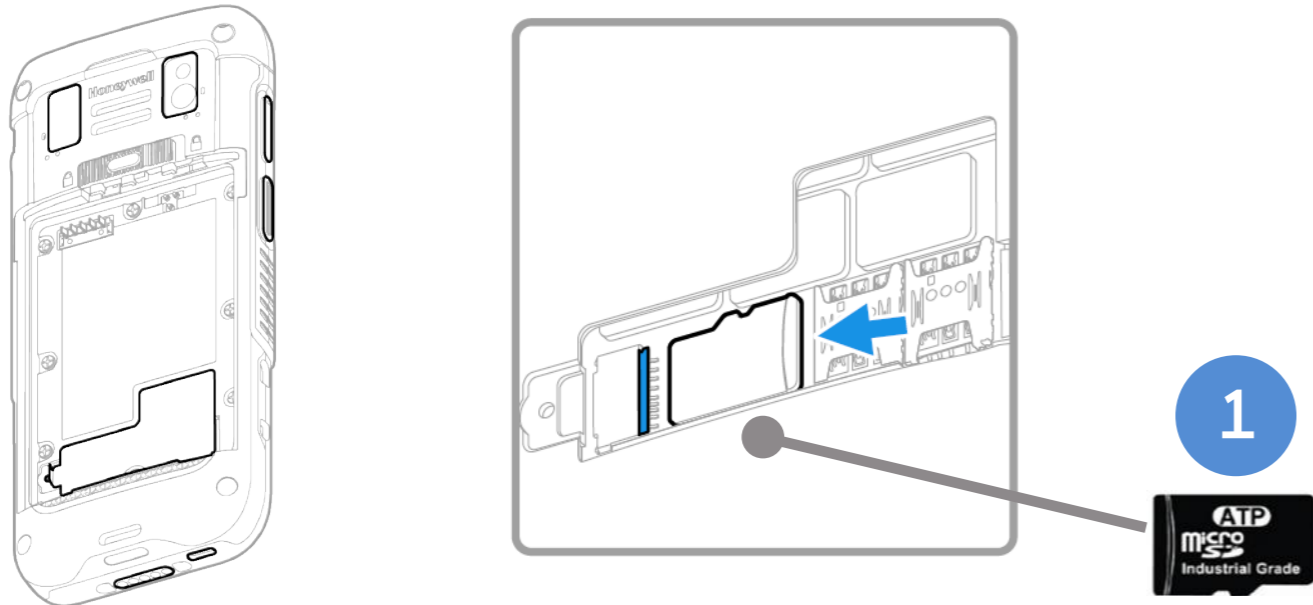

Why ATP Industrial Grade SD?

ATP's SIP (System-In-Packaging) manufacturing process encapsulates all exposed components and points of failure to ensure the products are fully waterproof, shockproof, and ESD (Electro-Static Discharge) proof. ATP Industrial Grade SD/SDHC Cards can withstand at least an operating/storage temperature range of at least -40 to 85 degrees Celsius. In addition to this temperature range, the cards are completely waterproof, dustproof, and ESD (Electro-Static Discharge) proof. All ATP Industrial Grade SD/SDHC cards are produced under a stringent RoHS and Green Package compliant manufacturing process to guarantee a consistent high level of build quality and performance. ATP Industrial SD cards deliver outstanding performance with read speed (seq) up to 18MB/sec and write speed (seq) up to 16MB/sec. All ATP Industrial Grade CF, SD, USB drives, and SSDs are constructed using best-in-class SLC(Single-Level Cell) components with enhanced Error Correction Code(ECC) functions and wear levelling algorithms. This results in MTBF ratings over 2 million hours and the highest write cycle lifetimes in the industry.

	PART NUMBER	DESCRIPTION
<b>1</b>	856-065-004	MICRO-SD CARD, <b>1GB</b> , AFIGUDI, ROHS
<b>OR</b>	856-065-005	MICRO-SD CARD, <b>2GB</b> , AFIGUDI, ROHS
<b>OR</b>	856-065-006	MICRO-SD CARD, <b>4GB</b> , AFIGUDI, ROHS
<b>OR</b>	856-065-007	MICRO-SD CARD, <b>8GB</b> , AFIGUDI, ROHS

## AC Cords

Regional Power Cords



AC Power - C13 Type Connector

PART NUMBER	TYPE	DESCRIPTION
50117501-001	C13	POWER CORD AUSTRALIA 2500MM,SLED CB
50117503-001	C13	Power cord, Argentina, Isled CB
321-501-002	C13	AC Power Cord, Denmark RoHS
77900508E	C13	Cable: power cord, straight, Power cord, Europe EU, IEC320-C13, 2.5 m (8.2 ft)
321-502-002	C13	AC Power Cord, India/South Africa RoHS
321-500-002	C13	AC Power Cord, Japan RoHS
9000093CABLE	C13	AC POWER CABLE, C14 TYPE, SWITZERLAND 3-PIN
77900507E	C13	Cable: power cord, straight - Power cord, UK, IEC320-C13, 2.5 m (8.2 ft)
130063	C13	AC Power Cord, US RoHS



AC Power - C5 Type Connector

PART NUMBER	TYPE	DESCRIPTION
3007-4681-001	C5	C5 type power cable, USA
3007-4683-001	C5	C5 type power cable, Europe
3007-4682-001	C5	C5 type power cable, UK
3007-4684-001	C5	C5 type power cable, Australia



# MISCELLANEOUS

## Disclaimer

---

Honeywell International Inc. (“HII”) reserves the right to make changes in specification and other information contained in this document without prior notice, and the reader should in all cases consult HII to determine whether any such changes have been made. The information in this publication does not represent a commitment on the part of HII.

HII shall not be liable for technical or editorial errors or omissions contained herein; nor for incidental or consequential damages resulting the furnishing, performance, or use of this material.

This document contains proprietary information that is protected by copyright. All rights are reserved. No part of this document may be photocopied, reproduced, or translated into another language with-out prior written consent of HII.

Web Address: [automation.honeywell.com](http://automation.honeywell.com)

The Bluetooth trademarks are owned by Bluetooth SIG, Inc., U.S.A and licensed to Honeywell.

Thor and Mobility Edge are trademarks or registered trademarks of Honeywell International Inc. in the United States and/or other countries.

Android is a trademark or registered trademark of Google Inc. in the United States and/or other countries. Windows is a trademark or registered trademark of Microsoft Corporation.

Qualcomm and Snapdragon are trademarks or registered trademarks of Qualcomm Incorporated in the United States and/or other countries.

Other product names mentioned in the manual may be trademarks of registered trademarks of their respective companies and are the property of their respective owners.

All rights reserved.

### For more information

[automation.honeywell.com](http://automation.honeywell.com)

### Honeywell Industrial Automation

855 S Mint St  
Charlotte, NC 28202  
800-582-4263  
[www.honeywell.com](http://www.honeywell.com)